



FITTING INSTRUCTIONS FOR

Shift Lock Release Button

SKU

KS1022

COMPATIBILITY

Toyota Prado 250

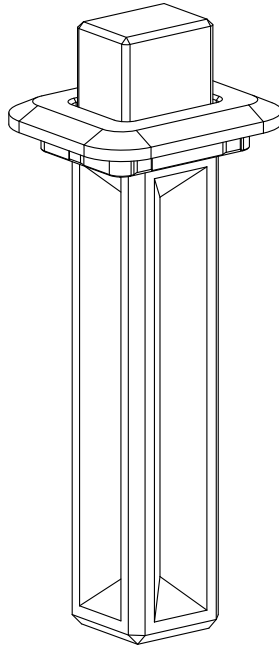

Included contents

QTY	COMPONENT
1	Shift Lock Shroud
1	Shift Lock Button



Time

5 minutes / Sip of beer

Scan the **QR code** to watch the video installation guide,
or for further information contact KAON on **07 3180 1470** or info@kaon.com.au



Bolt Torque

DIAMETER (mm)	5mm	6mm	8mm	10mm	12mm
NEWTON-METRES (Nm)	5 Nm	9 Nm	22 Nm	44 Nm	77 Nm

Let's get to work.

Installation

1. Using a pry tool to remove the small cover over the shift lock switch.
2. Unclip and lower the gear stick boot. Use a tool to push the metal clip out to release the gear knob. Remove the gear knob.
3. Finally, unclip and remove the gear shift trim.



Installation cont.

4. With the gear shift trim displaced, thread the shift lock button upwards through the opening where the original shift lock cover was located. Ensure that you thread the thinner end through first.
5. Holding the top of the button from the other side of the trim to prevent it from falling through, reinstate the gear shift trim.
6. Clip the shroud in place around the shift lock release button.
7. Reinstall the gear knob and remaining trim.
8. That's it – you're done!

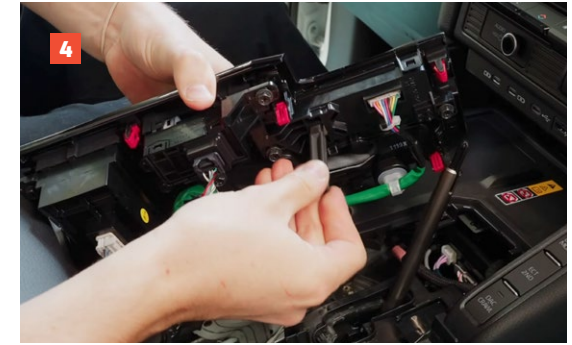



Local Knowledge & Assistance

We know half the fun of building your dream 4x4 is getting your hands dirty. But we also know that sometimes, things don't go to plan. If in the pursuit to build the ultimate setup you find yourself off-track, we're here to help you get unstuck.

For further information call 07 3180 1470 or email info@kaon.com.au

Disclaimer: The products sold by KAON should not be modified, and are for use only on the vehicles specifically stated. KAON will not be liable for any damages arising out of the use or misuse of it's products. It is the customers responsibility to ensure the products are safely and properly used and installed. KAON consistently seeks to improve it's products and reserves the right to make changes to any product.