



FITTING INSTRUCTIONS FOR

# Side Mirror Antenna Mount (RHS)

SKU

**KS0937**

COMPATIBILITY

**Nissan Patrol Y62**

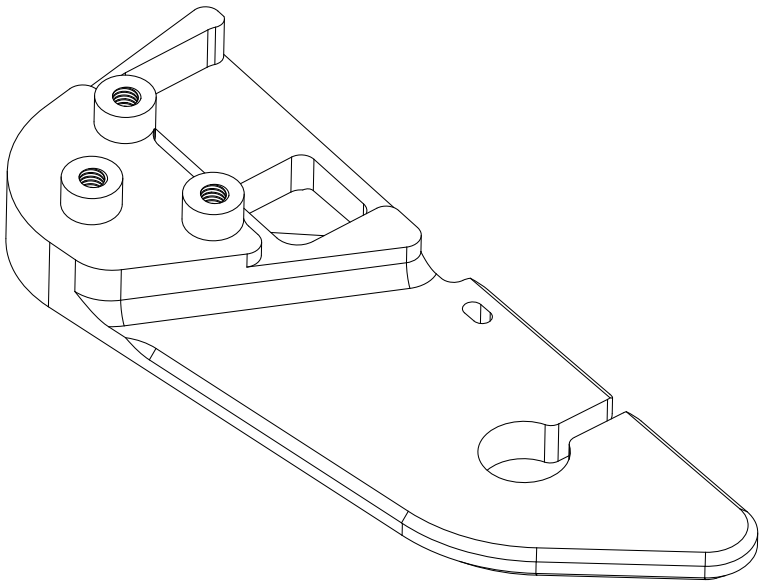

## Included contents

QTY	COMPONENT
1	Side Mirror Antenna Mount
3	M5 x 30 Socket Head Cap Screw
2	Self Adhesive Cable Tie Mount
5	Cable Tie



**Time**

30 minutes / Half a beer

For further information contact KAON on **07 3180 1470** or [info@kaon.com.au](mailto:info@kaon.com.au)

## G8.8 Bolt Torque (Non-Lubricated)

DIAMETER (mm)	5mm	6mm	8mm	10mm	12mm
NEWTON-METRES (Nm)	6 Nm	10 Nm	15 Nm	22 Nm	35 Nm

# Let's get to work.

---

## Preparation

1. Using a pry tool, unclip the panel underneath the mirror.
2. If your vehicle model has a puddle light, unclip this from the panel.
3. Apply tape underneath the mirror to protect the door's paint.



## Installation

4. There are two ways you can install your mirror mount and antenna.

A more concealed but labour intensive method is to route the cable through the mirror itself. This requires removing the mirror from the vehicle and widening the existing hole using a drill to accommodate the cable. The cable will also need to be fed behind the door trim and through a grommet into the cab of the vehicle.

We recommend a simpler method of attaching the mount to the mirror whilst on the vehicle and utilising the fire wall in the cabin to route the antenna cabling. The installation for this method will be covered in these instructions.

5. Remove the three M5 factory bolts located underneath the mirror.
6. If you have a puddle light, adhere it to the tape on your mirror mount by removing the film covering the double-sided tape on the inner surface of the mount.

If you do not have a puddle light, leave the film on the tape and proceed to the next step.

7. Secure the mirror mount to the vehicle using the supplied M5 x 30 screws. Tighten until secure.
8. Attach the antenna to the mirror mount.



## Routing the Cable

9. Adjacent to the mirror there is a gap between the front guard and the a-pillar/body of the vehicle. Feed the antenna cable through this gap, pulling it through into the engine bay. Ensure that you leave some slack.
10. Adhere one of the supplied adhesive cable tie mounts to the inside of the door, as pictured. We recommend ensuring the final placement of this will keep the antenna cable off the body of the vehicle.
11. Adhere the second to the cab, just below where the cable runs into the engine.
12. Secure the antenna cable to the mounts using the supplied cable ties. Run the cable slightly with a slight drop to prevent water run off being directed to the interior of the vehicle.



---

## Routing the Cable

13. Feed the rest of the cable through the grommet in the fire wall (indicated in red) and in to the UHF module.
14. That's it – you're done!  
We'll leave finalising the wiring of your new UHF to you.









### **Local Knowledge & Assistance**

We know half the fun of building your dream 4x4 is getting your hands dirty. But we also know that sometimes, things don't go to plan. If in the pursuit to build the ultimate setup you find yourself off-track, we're here to help you get unstuck.

**For further information call 07 3180 1470 or email [info@kaon.com.au](mailto:info@kaon.com.au)**

Disclaimer: The products sold by KAON should not be modified, and are for use only on the vehicles specifically stated. KAON will not be liable for any damages arising out of the use or misuse of its products. It is the customers responsibility to ensure the products are safely and properly used and installed. KAON consistently seeks to improve its products and reserves the right to make changes to any product.