



FITTING INSTRUCTIONS FOR

Auto Levelling Headlight Bracket

SKU

KS0857

COMPATIBILITY

**Toyota Prado 150, Prado 250
LandCruiser LC200 & LC300**

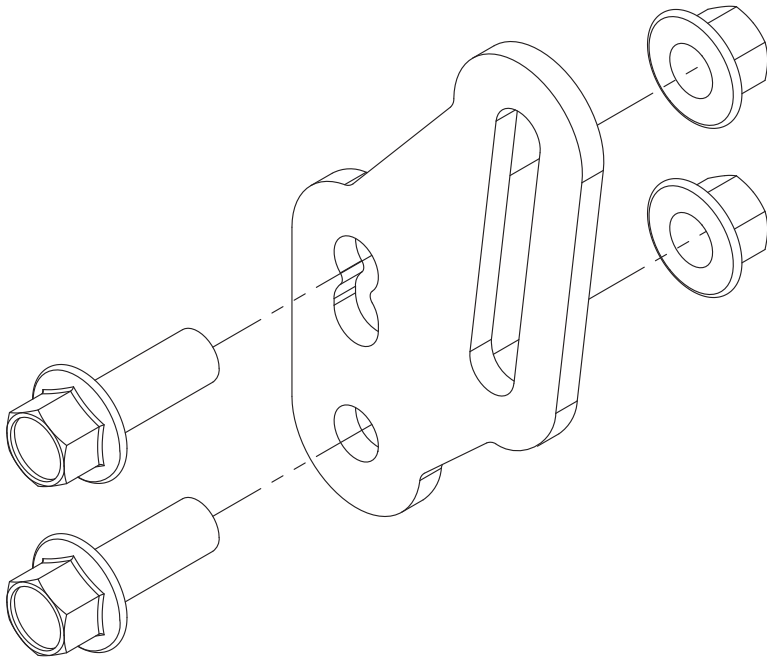

Included contents

QTY	COMPONENT
1	Headlight Levelling Bracket
2	M6 x 16 Flanged Hex Bolt G8.8
2	M6 Flanged Nut



Time

10 minutes / Few sips of beer

For further information contact KAON on **07 3180 1470** or info@kaon.com.au

The following instructions will vary, depending on your vehicle.

There are different installation steps for the Auto Levelling Headlight Bracket, depending on the kind of vehicle you are installing it to. Follow the steps as outlined below:

Prado 150

STEPS 1-6

Turn to page 4 for instructions on installing the Auto Levelling Headlight Bracket on the Prado 150.



LandCruiser LC200

STEPS 7-12

Turn to page 5 for instructions on installing the Auto Levelling Headlight Bracket on the LC200.



LandCruiser LC300 & Prado 250

STEPS 13-18

Turn to page 6 for instructions on installing the Auto Levelling Headlight Bracket on the LC300.



G8.8 Bolt Torque (Non-Lubricated)

DIAMETER (mm)	5mm	6mm	8mm	10mm	12mm
NEWTON-METRES (Nm)	6 Nm	10 Nm	15 Nm	22 Nm	35 Nm

Let's get to work.

Prado 150 Installation

1. Locate the sensor arm mounting slot on the rear upper trailing arm adjacent to the rear axle. Remove the nut connecting it to the factory mount.
2. Place the headlight levelling bracket behind the factory mount and thread through the two supplied M6 bolts. Ensure that they are secured through the bolt holes indicated in red.
3. Fasten the bracket to the factory mount using the M6 nuts.
4. Secure the sensor arm to the elongated slot in the headlight levelling bracket, using the factory nut.
Please note: the factory washer has a small tab to stop the thread spinning in place, ensure this tab sits on the outside of the headlight levelling bracket as pictured.
5. The factory sensor moving arm has a small circular indicator that lines up with a corresponding indicator on the stationary sensor body. Make sure these two indicators align whilst the vehicle is at ride height. This can be done by eye, or feeding a small screwdriver through the two holes. Once this is done, tighten all bolts to the recommended torque settings.
6. That's it, you're done!

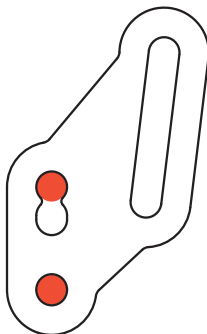
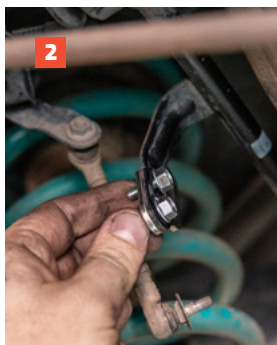
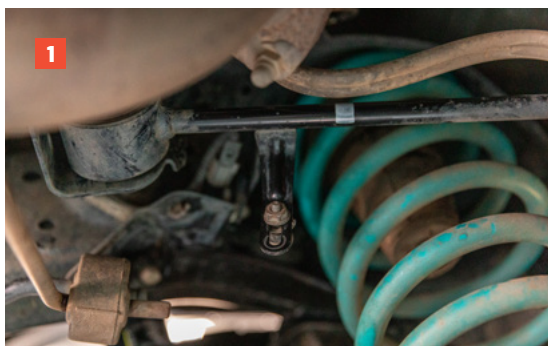

LC200 Installation

7. Locate the sensor arm mounting slot on the rear upper trailing arm adjacent to the rear axle. Remove the nut connecting it to the factory mount.
8. Position the headlight levelling bracket in front of the factory mount and thread through the two supplied M6 bolts. Ensure that they are secured through the bolt holes indicated in red.
9. Fasten the bracket to the factory mount using the M6 nuts.
10. Secure the sensor arm to the elongated slot in the headlight levelling bracket, using the factory nut.

Please note: the factory washer has a small tab to stop the thread spinning in place, ensure this tab sits on the outside of the headlight levelling bracket as pictured.

11. The factory sensor moving arm has a small circular indicator that lines up with a corresponding indicator on the stationary sensor body. Make sure these two indicators align whilst the vehicle is at ride height. This can be done by eye, or feeding a small screwdriver through the two holes. Once this is done, tighten all bolts to the recommended torque settings.
12. That's it, you're done!

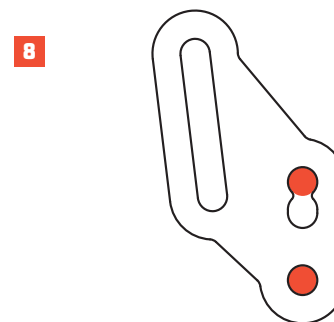
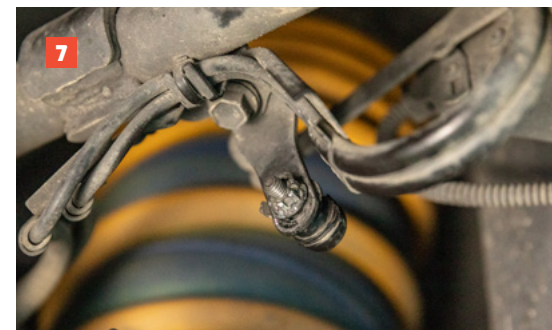

LC300 & Prado 250 Installation

13. Locate the sensor arm mounting slot on the rear upper trailing arm adjacent to the rear axle. Remove the nut connecting it to the factory mount.

14. Position the headlight levelling bracket in front of the factory mount and thread through the two supplied M6 bolts. Ensure that they are secured through the bolt holes indicated in red.

15. Fasten the bracket to the factory mount using the M6 nuts.

16. Secure the sensor arm to the elongated slot in the headlight levelling bracket, using the factory nut.

Please note: the factory washer has a small tab to stop the thread spinning in place, ensure this tab sits on the outside of the headlight levelling bracket as pictured.

17. The moving arm of the factory sensor has a small fold along its top edge. Using a bubble level, make sure this fold is level at ride height – then tighten all the bolts to the recommended torque settings.

18. That's it, you're done!

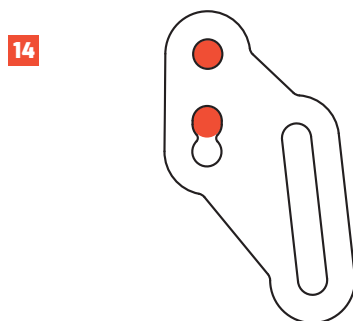
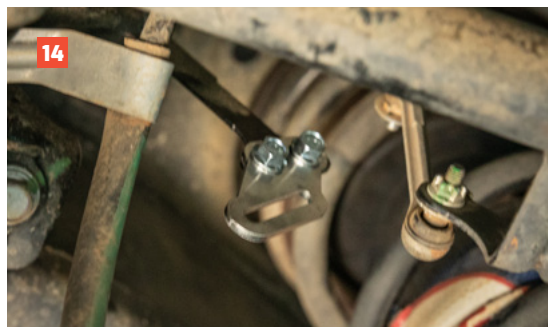



Local Knowledge & Assistance

We know half the fun of building your dream 4x4 is getting your hands dirty. But we also know that sometimes, things don't go to plan. If in the pursuit to build the ultimate setup you find yourself off-track, we're here to help you get unstuck.

For further information call 07 3180 1470 or email info@kaon.com.au

Disclaimer: The products sold by KAON should not be modified, and are for use only on the vehicles specifically stated. KAON will not be liable for any damages arising out of the use or misuse of its products. It is the customers responsibility to ensure the products are safely and properly used and installed. KAON consistently seeks to improve its products and reserves the right to make changes to any product.