



FITTING INSTRUCTIONS FOR

# Exterior Rear Molle Panel

SKU

**KS0919/920**

COMPATIBILITY

**Toyota Prado 150**

VARIANT

**Platform Rack**

**KS0920 (RHS)**

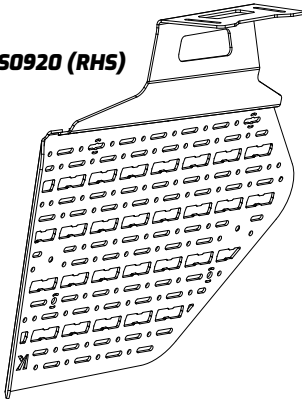

**KS0919 (LHS)**

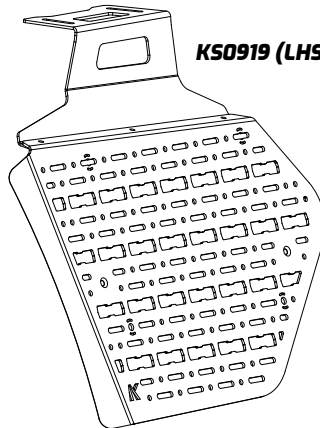

## KS0919/920 Included contents

| QTY | COMPONENT                        | QTY | COMPONENT                |
|-----|----------------------------------|-----|--------------------------|
| 1   | External Molle (LHS OR RHS)      | 2   | M8 x 24 x 2.0 DIN Washer |
| 1   | Upper Mount Bracket (LHS OR RHS) | 5   | M8 Nyloc Nut             |
| 2   | M8 x 12 Countersunk Socket Screw | 2   | SwitchBolt               |
| 3   | M8 x 20 Button Head Socket Screw | 2   | SwitchBolt Retainer      |
| 6   | M8 x 16 x 1.5 Washer             | 2   | 4.5" Suction Cup         |
|     |                                  | 2   | Suction Cup Bushing      |



**Time**

30 minutes / Half a beer

Scan the **QR code** to watch the video installation guide,  
or for further information contact KAON on **07 3180 1470** or **info@kaon.com.au**



# Things to consider before mounting your Exterior Molle.

When using the Exterior Molle Panels to mount accessories to the rear of your vehicle, there are a few things to consider before installation to ensure best practice, safe use and legal compliance.

## **1. Roof Rack Loading**

**The Exterior Molle Panels contribute to the overall weight of your roof rack.**

As the Exterior Molles are mounted directly to the roof rack, the Panels themselves and any accessories mounted to them will contribute to the overall weight of the rack. It is therefore important to consider the load rating of your rack and ensure that the combined weight of all accessories and the panels do not exceed it.

## **2. Exterior Molle Panel Loading**

**Ensure that you adhere to the weight limit when mounting accessories to the panels.**

The maximum load each panel can safely carry is 20kg. Ensure that the mounted accessories do not exceed this limit. We recommend mounting Items heavier than 20kgs directly to the roof rack or inside the vehicle.

## **3. Mounting Dangerous Goods**

**We do not recommend mounting dangerous goods such as petrol to the Exterior Molle Panels.**

Although you may be able to legally mount fuel or other dangerous goods on the Exterior Molle Panels under your local jurisdiction, we advise against using them for this purpose. Refer to **Page 4** for examples of recommended uses for your Exterior Molles instead.

## **4. Installing with an Awning in Place**

**Installing an Exterior Molle with an awning is possible, but requires additional steps.**

Prior to installing the Exterior Molle you will need to ensure your awning brackets are clear of the mounting space. You will then need to determine whether there is enough space between the awning and rack/vehicle for you to simply feed through the molle's upper mount bracket to attach the panel, or whether you will need to remove awning entirely. These adjustments will need to be made prior to starting this installation.

## **5. Checks and Maintenance**

**We recommend doing regular checks and maintenance on your Exterior Molle Panels.**

Best practice when using the Exterior Molle Panels includes regularly checking that the suction cups are still fully engaged, ensuring that any mounted accessories are securely fastened and checking that hardware securing them to the rack is also correctly fastened.

## 6. Legal Compliance for Vehicle Projections

There are legal requirements regarding vehicle projections that must be considered when mounting to the exterior of your vehicle.

Under the Load Restraint Guide for Light Vehicles (2018) by the Australian National Transport Commission, projections must not exceed 150mm from the outermost part of the vehicle on either side. Additionally, the total width of the vehicle and protrusions must not exceed 2500mm.

If you are located outside of Australia, we recommend contacting your local regulatory body to confirm what the legal requirements are for vehicle projections in your area.

Demonstrated below is how to measure the distance from the outermost point on the vehicle. In this example, any accessories mounted on the exterior molle panels must not exceed beyond the blue line.

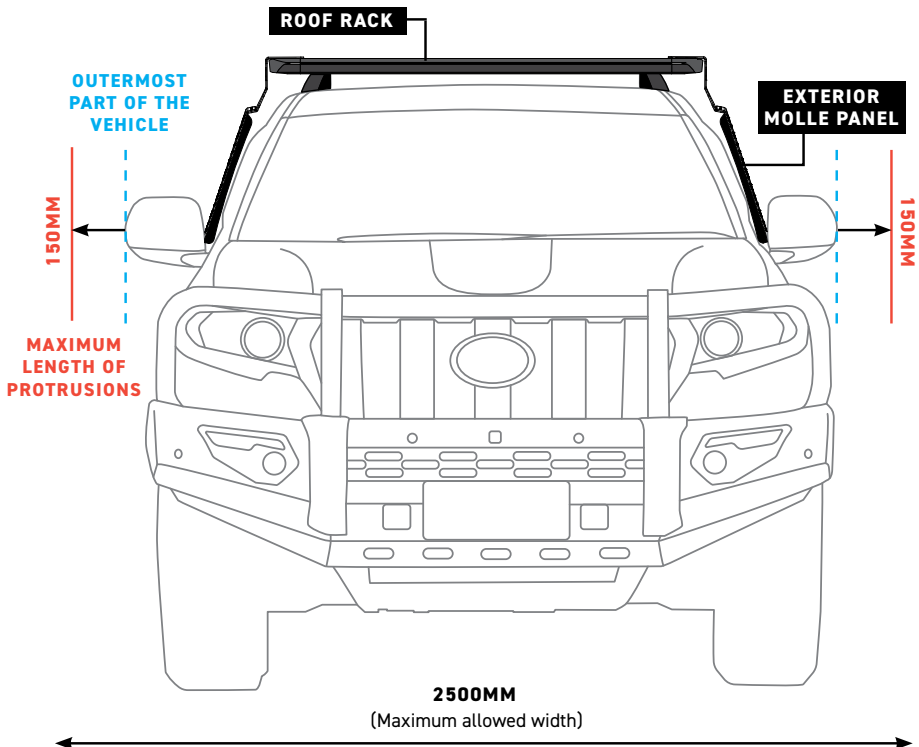

# Recommended uses for the Exterior Molle Panel.

The Exterior Molle Panel was designed with a mesh configuration to suit a number of common camping and touring accessories. Indicated below are examples of accessories suitable for the panel and where you may want to position them on the panel.

This is intended as a guide only, as the accessories you can mount and their location on the panel are not limited to what is displayed here. We recommend determining the configuration that works best for your set-up and the gear you would like to mount.

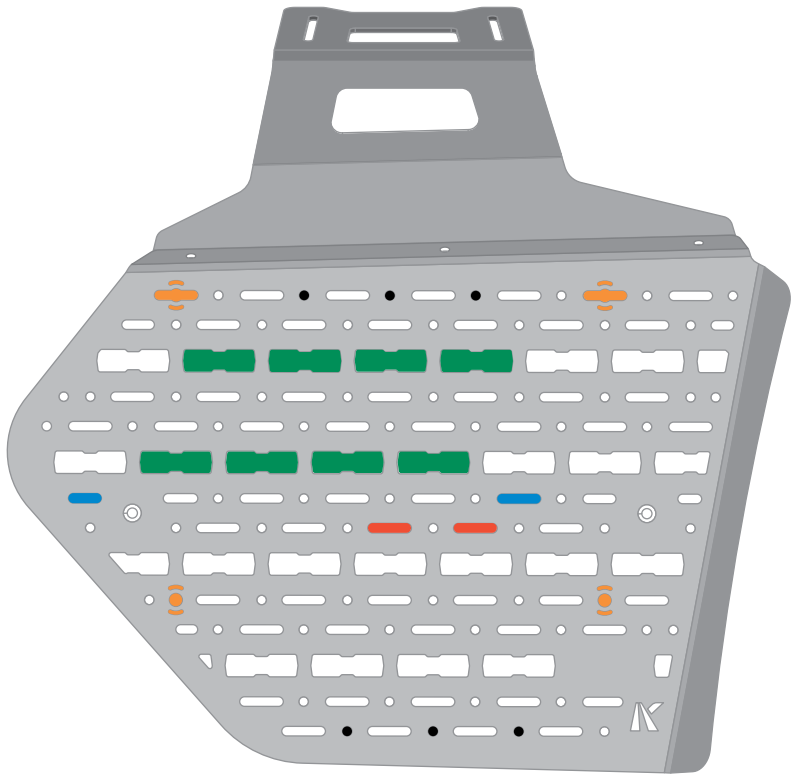

**MAXTRAX  
MINI**



**VAAST  
TANKS**



**ROTOPAX  
CONTAINERS**



**MOLLE/  
PALS MESH**



**GENERAL  
ACCESSORIES**

# Let's get to work.

---

## Assembling the Panels

1. Attach the upper bracket to the main to the Molle Panel, using the supplied M8 Hardware. Ensure that you sandwich a washer on both sides, under the nyloc nut and bolt.
2. Loosely attach the suction cup to the rear of the Molle Panel at the countersunk mounting holes, using the supplied countersunk bolts. Ensure that the supplied TPU bushing is sandwiched between the panel and suction cup.
3. Ensure that the pump on the rearward suction cup is pointing towards the back of the vehicle, while the front suction cup pump should be directed towards the front of the vehicle
4. It's easiest to secure any accessories to your Exterior Molle Panel first as it will be more difficult once the panel is mounted to the vehicle. We recommend first completing a test fit to work out the best configuration for your setup, and to ensure access to the back doors.

Refer to Page 4 for recommendations on mounting common accessories.

5. Loosely attach the accessories to the panel and mockup the position of the panel on the vehicle.
6. Ensure that you can still access the pumps on the suction cups and close the door with the accessories installed.
7. Once the accessory configuration is confirmed, tighten all the hardware excluding the countersunk bolts attaching the suction cups.

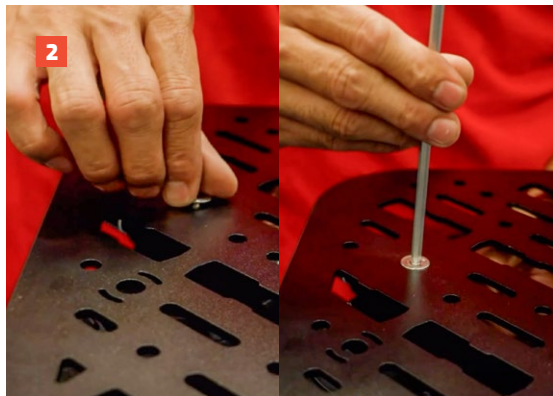

## Installation

8. Thoroughly clean the rear windows with glass cleaner.
9. In the outermost slat of your roof rack place two SwitchBolts in position over the rear window.
10. Turn the SwitchBolt in the channel, until it sits securely up against the sides, as pictured.
11. Place the retainer over the SwitchBolt to lock its position in the channel. The retainer must be used in order to secure the bolt's position.
12. Place the Exterior Molle Panel over these bolts.
13. Make sure the panel is in alignment with the shape of the rear window, and check all clearances. Ensure that the suction cup surfaces are positioned parallel to the glass. Their position in relation to the glass can be adjusted using the slots where the upper mount secures to the rack.
14. Secure the panel in position by fastening a washer and nyloc nut over each SwitchBolt.
15. Tighten these bolts to the advised torque settings on the back cover of these instructions.

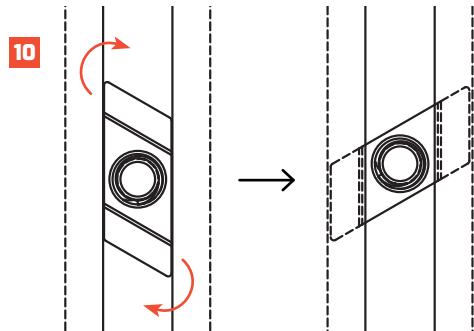

---

## Installation cont.

16. Remove the covers on the suction cup and push them against the glass.
17. To secure the cup to the glass, apply slight pressure to the panel and pump the mechanism until the white indicator line is no longer visible. This indicates that there is sufficient vacuum and the cup is secure to the vehicle.
18. Tighten the countersunk bolts in the suction cups.
19. That's it, you're done!  
If you're mounting another Exterior Molle Panel, repeat these installation steps on the other side of your vehicle.

We recommend periodically checking the suction cup vacuum indicators as part of your vehicle maintenance.



## G8.8 Bolt Torque (Non-Lubricated)

| DIAMETER (mm)      | 5mm  | 6mm   | 8mm   | 10mm  | 12mm  |
|--------------------|------|-------|-------|-------|-------|
| NEWTON-METRES (Nm) | 6 Nm | 10 Nm | 15 Nm | 22 Nm | 35 Nm |



### Local Knowledge & Assistance

We know half the fun of building your dream 4x4 is getting your hands dirty. But we also know that sometimes, things don't go to plan. If in the pursuit to build the ultimate setup you find yourself off-track, we're here to help you get unstuck.

For further information call 07 3180 1470 or email [info@kaon.com.au](mailto:info@kaon.com.au)

Disclaimer: The products sold by KAON should not be modified, and are for use only on the vehicles specifically stated. KAON will not be liable for any damages arising out of the use or misuse of it's products. It is the customers responsibility to ensure the products are safely and properly used and installed. KAON consistently seeks to improve it's products and reserves the right to make changes to any product.