



FITTING INSTRUCTIONS FOR

Side Molle Panels

SKU

KS0790

COMPATIBILITY

INEOS Grenadier Wagon Models

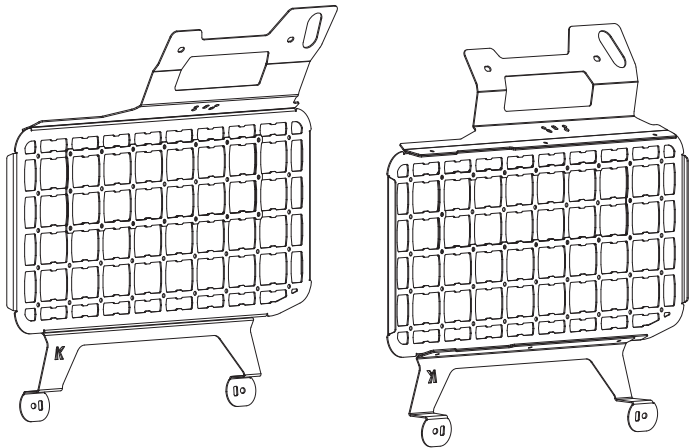

Included contents

QTY	COMPONENT	QTY	COMPONENT
2	Side Molle Panel (LHS & RHS)	2	Barrier Bushing
2	Upper Mounting Bracket (LHS & RHS)	2	Handle Plug
2	Lower Mounting Bracket (LHS & RHS)	4	M8 X 35 Button Head Cap Screw
2	Molle Infill Panel	4	M8 x 24 x 2.0 DIN Washer
4	Handle Spacer	24	M6 x 12 Button Socket Screw
4	O-Ring	24	M6 Flanged Nut



Time

30 minutes / Half a beer

For further information contact KAON on **07 3180 1470** or info@kaon.com.au

It all works together.

All our storage products work together, but there is a certain order to installing.
Let's work out the best order for your setup, shall we?

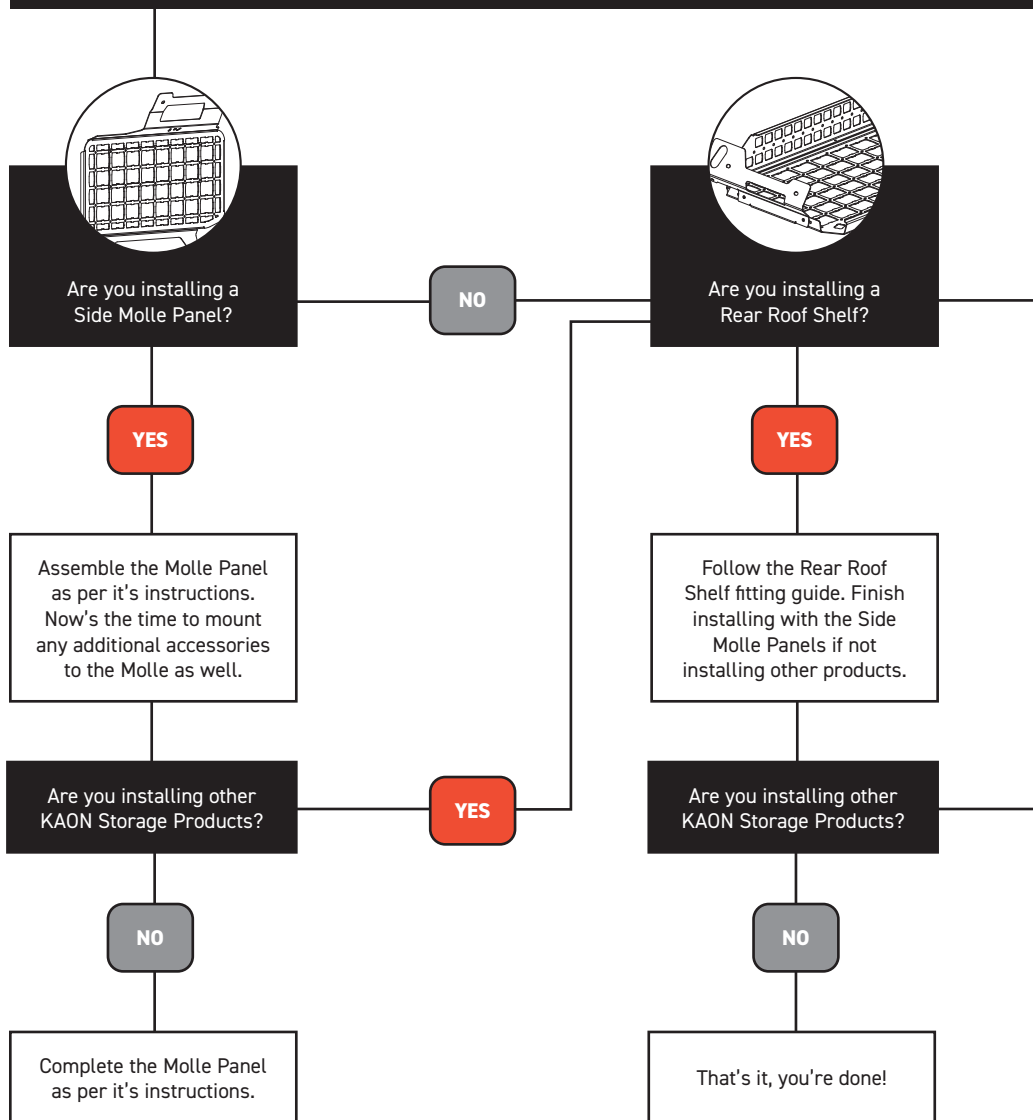

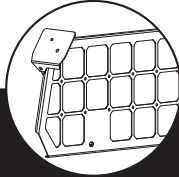
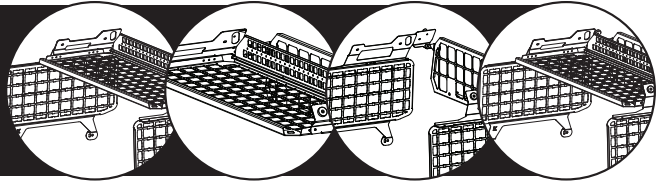

Are you installing a
Light Cargo Barrier?

NO

YES

The last piece of the
puzzle! Follow the
instructions for the Light
Cargo Barrier. Complete
the install of all interior
storage products.

Are you installing other
KAON Storage Products?

YES

NO

That's it, you're done!

YES

With the foundation in
place, it's time to mount
any other accessories,
such as a Cargo Divider,
Travel Buddy, etc. Have
fun making it your own.

With your setup order sorted, let's get to the good part: installing. →

Bolt Torque

DIAMETER (mm)	5mm	6mm	8mm	10mm	12mm
NEWTON-METRES (Nm)	5 Nm	9 Nm	22 Nm	44 Nm	77 Nm

Let's get to work.

Preparing the Vehicle

1. The factory INEOS cargo barrier is compatible with the Molle Panels, but you will need to remove it before installing your interior storage products. You will also need to remove the lower mounting brackets for the cargo barrier at the same time, keeping these handy as they will be reinstalled at a later stage.
2. Now it's time to reveal the vehicle's rear mounting points. Using a pry tool and an allen key, remove the factory plastics in the vehicle's headliner.
3. Using a torx bit, remove the tie down points below the rear windows. Now you can get to the good part — installing your Molle Panels!

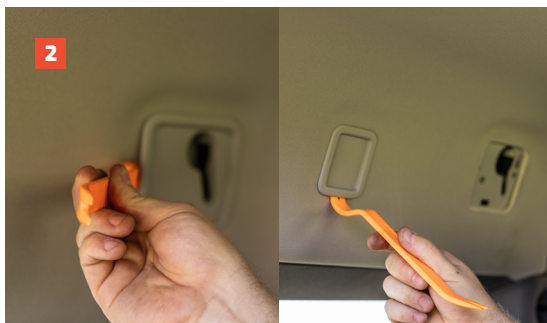

Assembling the Molle Panels

4. First, we need to assemble the Molle Panels. Attach both the upper and lower mounting brackets to the panel using the M6 hardware.

Some of the brackets have matching notches on the backside of the folds, as pictured. These indicate the bracket that is to be positioned on the driver's side of the vehicle, and will help discern left from right.

To optimise clearance when installed, be sure to have the dome head on the mounting bracket side and the nut on the panel side.

5. You'll notice an opening on both Molle Panels. We've supplied two infill panels for these, so you can choose to run them as a flush Molle Panel surface when fitted, or as a pocket for soft items if not fitted.

Consider what application best suits your setup and needs before attaching the infill panels with six M6 fasteners and nuts on each side. The panels can be added or removed at a later stage, if desired.

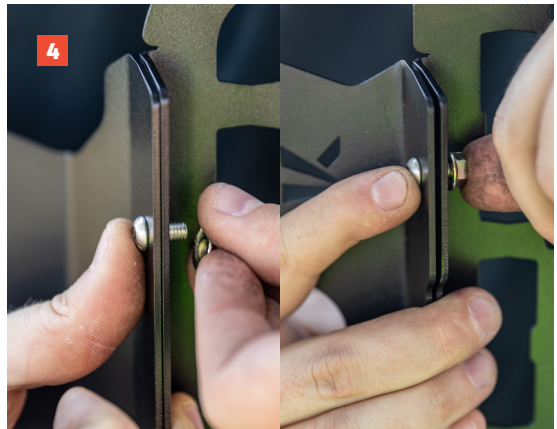

Installing the Molle Panels

6. With the Molle Panels assembled, prepare the upper mounting bracket for installation:

If you're installing a KAON Standalone Shelf OR Light Cargo Barrier: to install in conjunction with your Molle Panels, refer to the instructions for each interior storage before finishing the Molle Panel installation.

If you plan to install both a Standalone Shelf and a Light Cargo Barrier with the Molle Panels: refer to the Standalone Shelf instructions for the steps on securing the upper mounting bracket, before finishing the Molle Panel installation.

7. Thread the supplied M8 x 35 bolt and washer through the upper mounting bracket, as pictured.
8. On the other side of the upper mounting bracket, thread the supplied spacer over the bolt. You will notice that one side has a beveled inside edge, as pictured. Ensure this edge is facing outward from the bracket.
9. Place the o-ring over the bolt and push down so it sits within the beveled edge of the spacer. This will help to hold everything securely.

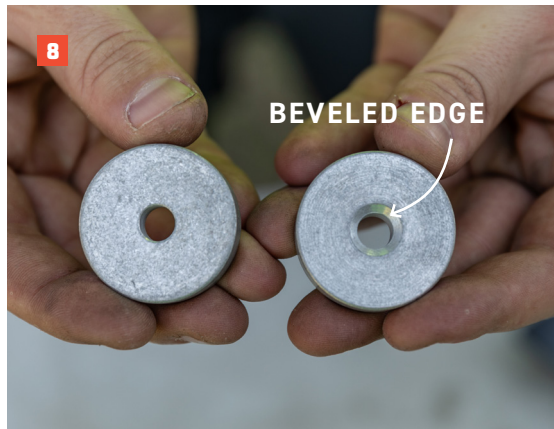

Finishing the Install

10. With the hardware fixed to both upper mounting brackets, position them against the captive mounts in the roof of the vehicle. Tighten the bolts until they are secure.
11. Use the factory tie down points to attach the lower mounting brackets below the window. Ensure that the tie down point is oriented correctly in the opening on the bracket.
12. **If you're re-using the factory cargo barrier:** you will need to re-attach the upper and lower mounts now, through the lower Molle Panel mount.

To re-install the factory barrier, push the two supplied bushings over the ends of the factory cargo barrier upper mounts. These will take up any slack caused by removing the factory trim and will stop rattles. Once these have been attached, the factory barrier can be reinstalled.

13. **If you're not using the factory cargo barrier:** There are two blanking plates supplied to fill in the empty spaces in the mounting bracket. Simply push into place, as pictured.
14. That's it! You're done.
All that's left to do now is to customise your Molle Panels with storage pods and 12V accessories, exactly how you like it.
We'll leave that up to you.





Local Knowledge & Assistance

We know half the fun of building your dream 4x4 is getting your hands dirty. But we also know that sometimes, things don't go to plan. If in the pursuit to build the ultimate setup you find yourself off-track, we're here to help you get unstuck.

For further information call 07 3180 1470 or email info@kaon.com.au

Disclaimer: The products sold by KAON should not be modified, and are for use only on the vehicles specifically stated. KAON will not be liable for any damages arising out of the use or misuse of its products. It is the customers responsibility to ensure the products are safely and properly used and installed. KAON consistently seeks to improve its products and reserves the right to make changes to any product.