



FITTING INSTRUCTIONS FOR

Standalone Rear Roof Shelf

SKU

KS0747

COMPATIBILITY

Toyota Prado 120 / Lexus GX 470

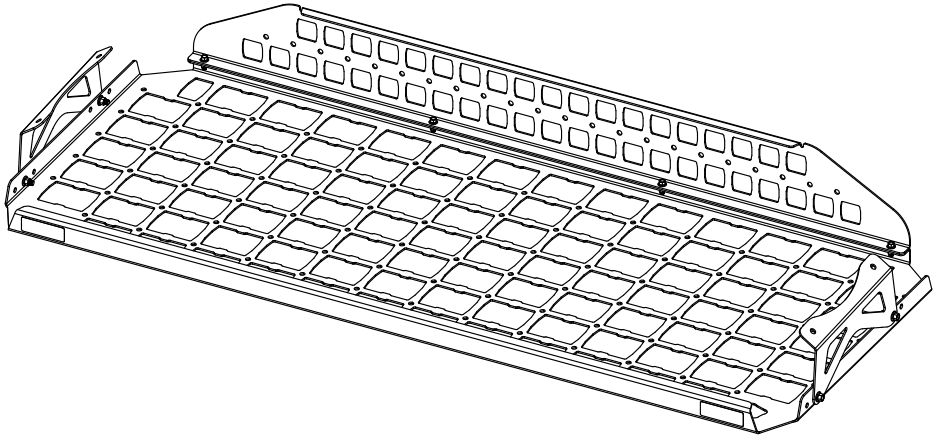

Included contents

QTY	COMPONENT	QTY	COMPONENT
1	Rear Roof Shelf	4	M5 x 12 Flanged Hex Bolts
1	Rear Fence	4	M5 Flanged Nuts
2	Handle Brackets	4	M6 x 16 Flanged Bolts
		4	M6 Flanged Nuts



Time

30 minutes / Half a beer

Scan the **QR code** to watch the video installation guide,
or for further information contact KAON on **07 3180 1470** or info@kaon.com.au



It all works together.

All our storage products work together, but there is a certain order to installing.
Let's work out the best order for your setup, shall we?

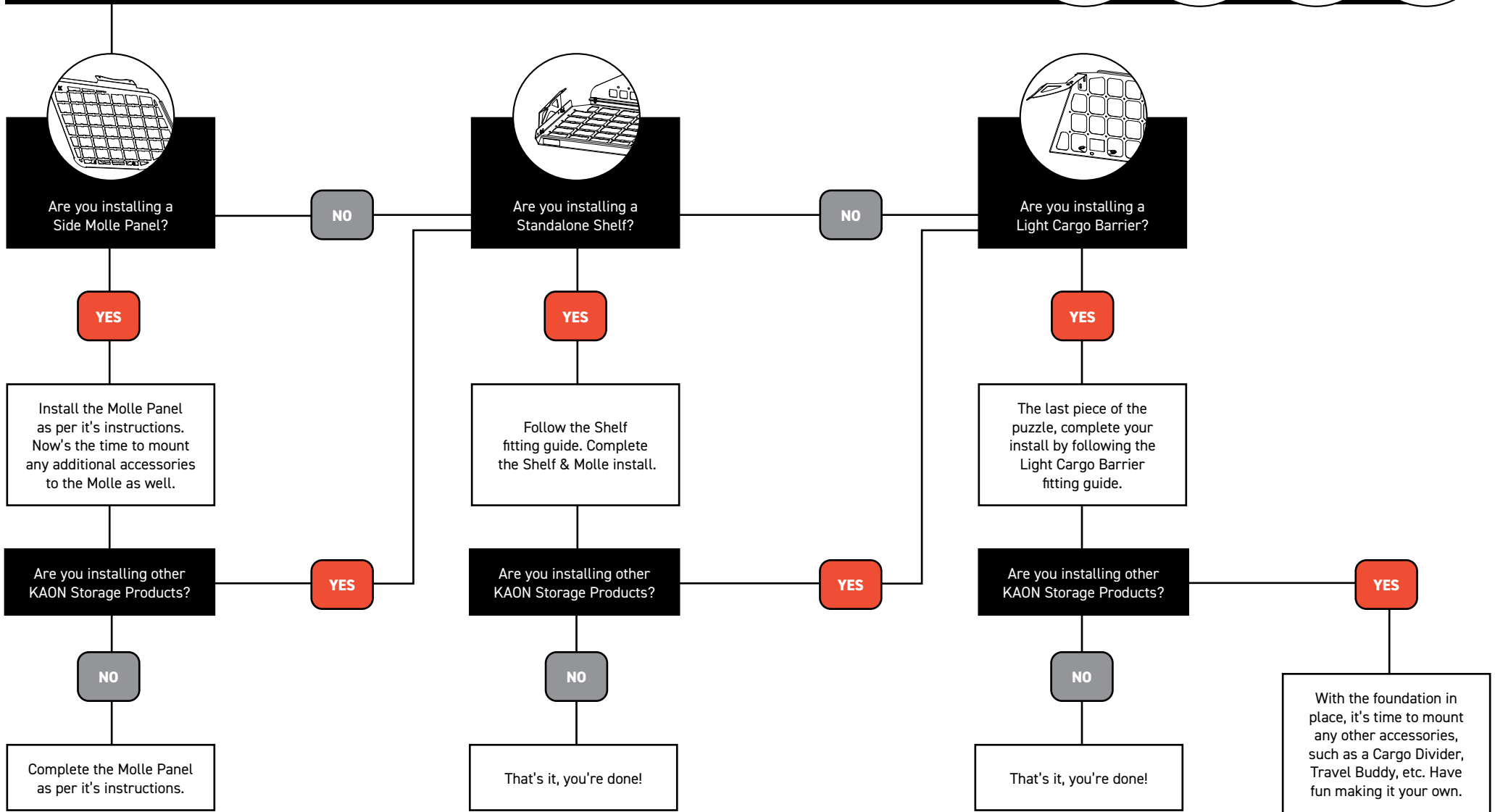
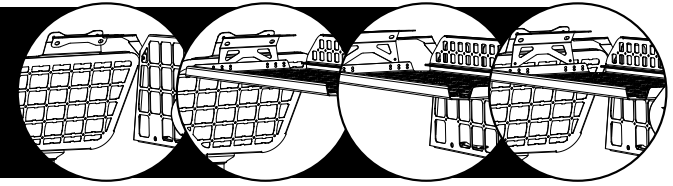

With your setup order sorted, let's get to the good part: installing. →

Let's get to work.

Preparing the Vehicle

1. Whether you're starting from a factory rear, or with existing KAON accessories, we need to remove the rear row grab handles.

Remove the grab handles by prying open the plastic cover and removing the bolts with a socket.



Assembling the Shelf

2. Attach the rear fence to the shelf using M5 nuts and bolts.
3. Tighten to secure.

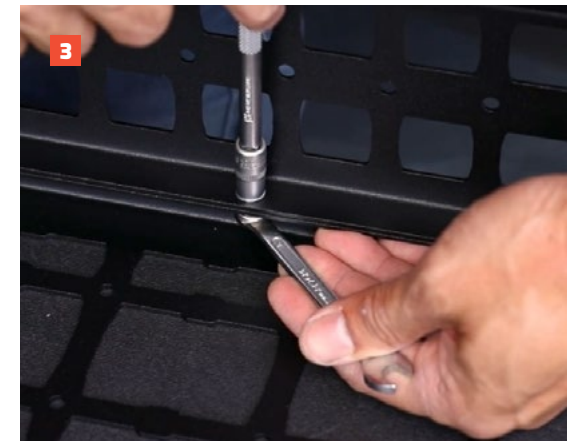
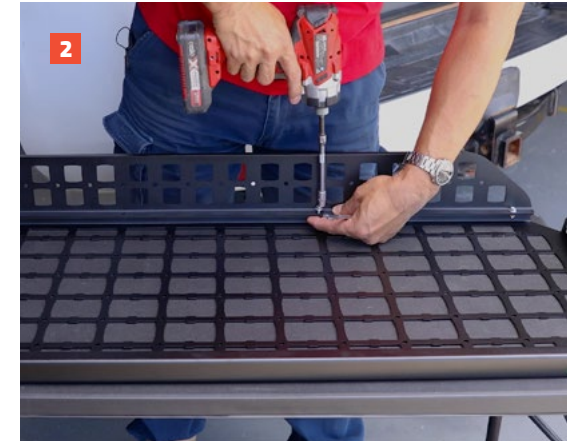

Installing the Brackets

4. Thread the Handle Brackets over the rear grab handles, ensuring the orientation as pictured. Ensuring the nutsert is towards the front of the vehicle, tighten to secure.

To install with the Side Molle Panels and/or Light Cargo Barrier:

Follow the installation order on page 3. If installing multiple products, the Standalone Shelf Handle Brackets should be layered over the Side Molle Panel, and sandwiched under the Barrier Handle Brackets.

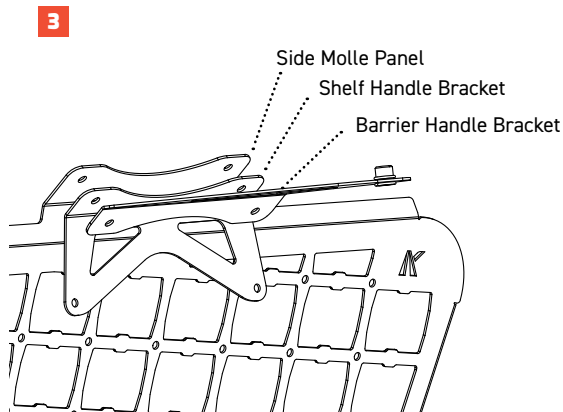
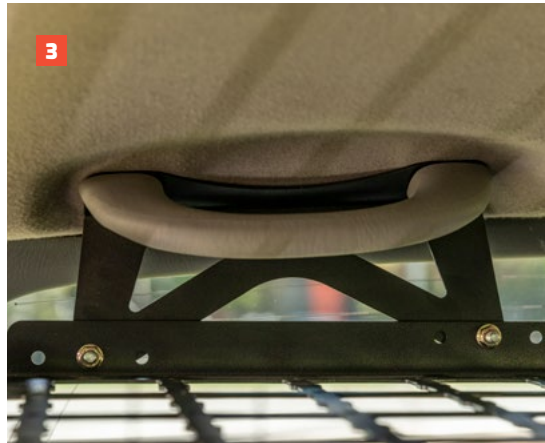

Installing the Shelf

5. With the brackets up, it's time to install the shelf itself. Whilst this can be done on your own, you may find it easier to ask a mate for help.
6. Position the shelf and use the M6 bolts and nuts to install the shelf to the bracket. There are a couple of positions for adjustment in your shelf positioning.
7. With the shelf position confirmed, tighten all the bolts.
8. That's it! Your new shelf is able to hold a recommended maximum load of 10kg. It also has some handy hooks to hang bags, and twin bottle openers on each side.

If you're adding a Light Cargo Barrier:

9. Follow steps 3-8 in the Light Cargo Barrier instructions to assemble and install.



Bolt Torque

DIAMETER (mm)	5mm	6mm	8mm	10mm	12mm
NEWTON-METRES (Nm)	5 Nm	9 Nm	22 Nm	44 Nm	77 Nm

NOTICE

We cannot confirm compatible fitment of this shelf with child restraints, due to the number of possible variations. Whilst it may work with your configuration, we recommend the use of a seat belt protector where any contact occurs between any seat belt or restraint and the shelf.



Local Knowledge & Assistance

We know half the fun of building your dream 4x4 is getting your hands dirty. But we also know that sometimes, things don't go to plan. If in the pursuit to build the ultimate setup you find yourself off-track, we're here to help you get unstuck.

For further information call 07 3180 1470 or email info@kaon.com.au

Disclaimer: The products sold by KAON should not be modified, and are for use only on the vehicles specifically stated. KAON will not be liable for any damages arising out of the use or misuse of its products. It is the customers responsibility to ensure the products are safely and properly used and installed. KAON consistently seeks to improve its products and reserves the right to make changes to any product.