



FITTING INSTRUCTIONS FOR

Rear Door Utensil Cage

SKU

KS0713/714

COMPATIBILITY

Toyota Prado 120, Lexus GX 470

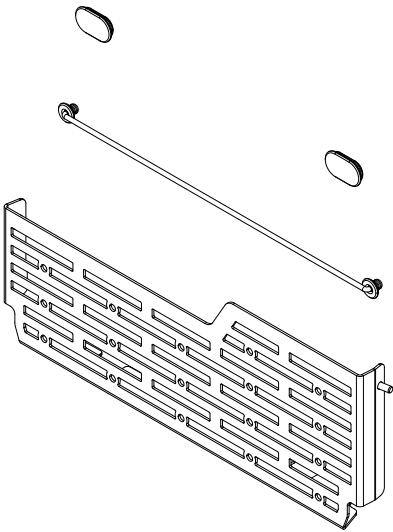

Included contents

QTY	COMPONENT	QTY	COMPONENT
1	Utensil Cage	2	Trim Plugs
2	Self Tapping Screw	2	Retainer TPU Plugs
		1	Retainer Bungee Cord



Time

30 minutes / Half a beer

For further information contact KAON on **07 3180 1470** or info@kaon.com.au

It all works together.

All our rear door products work together, but there is a certain order to installing.
Installing multiple products? Here's the the best way for your configuration.

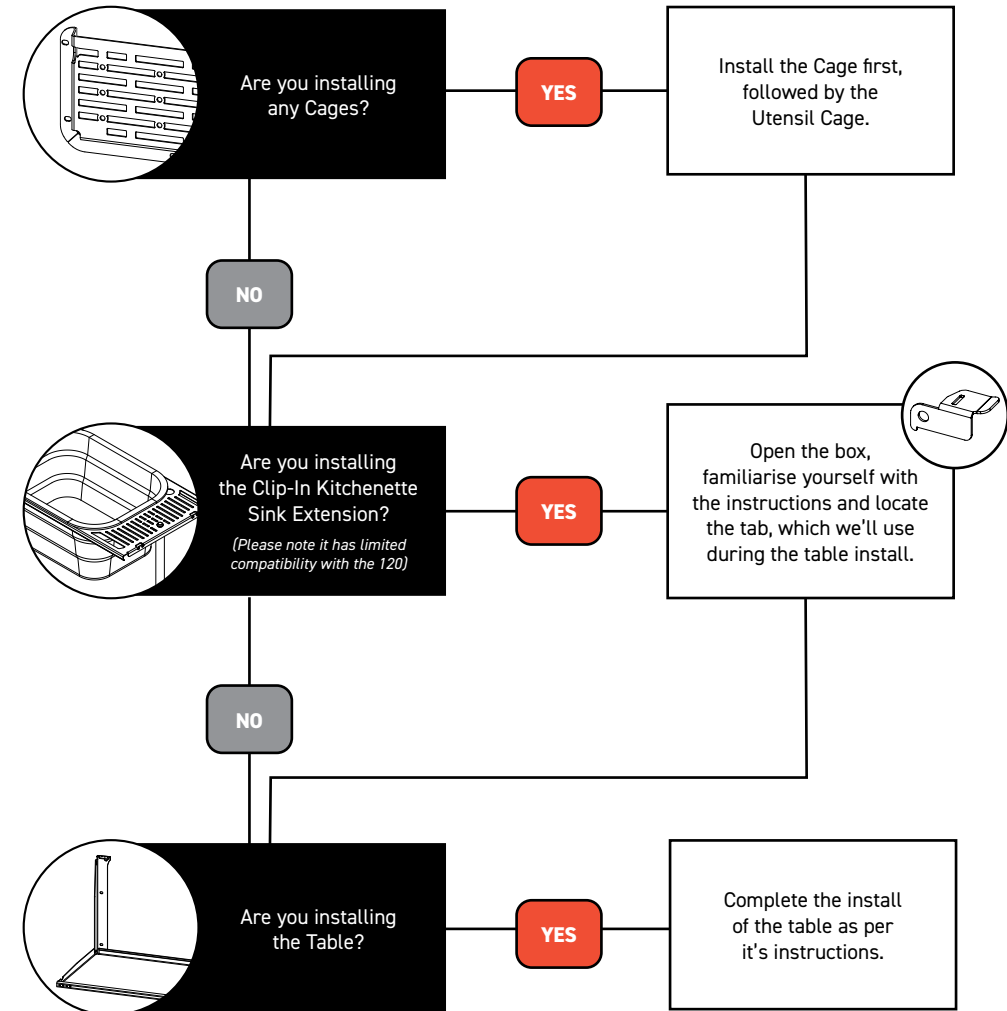
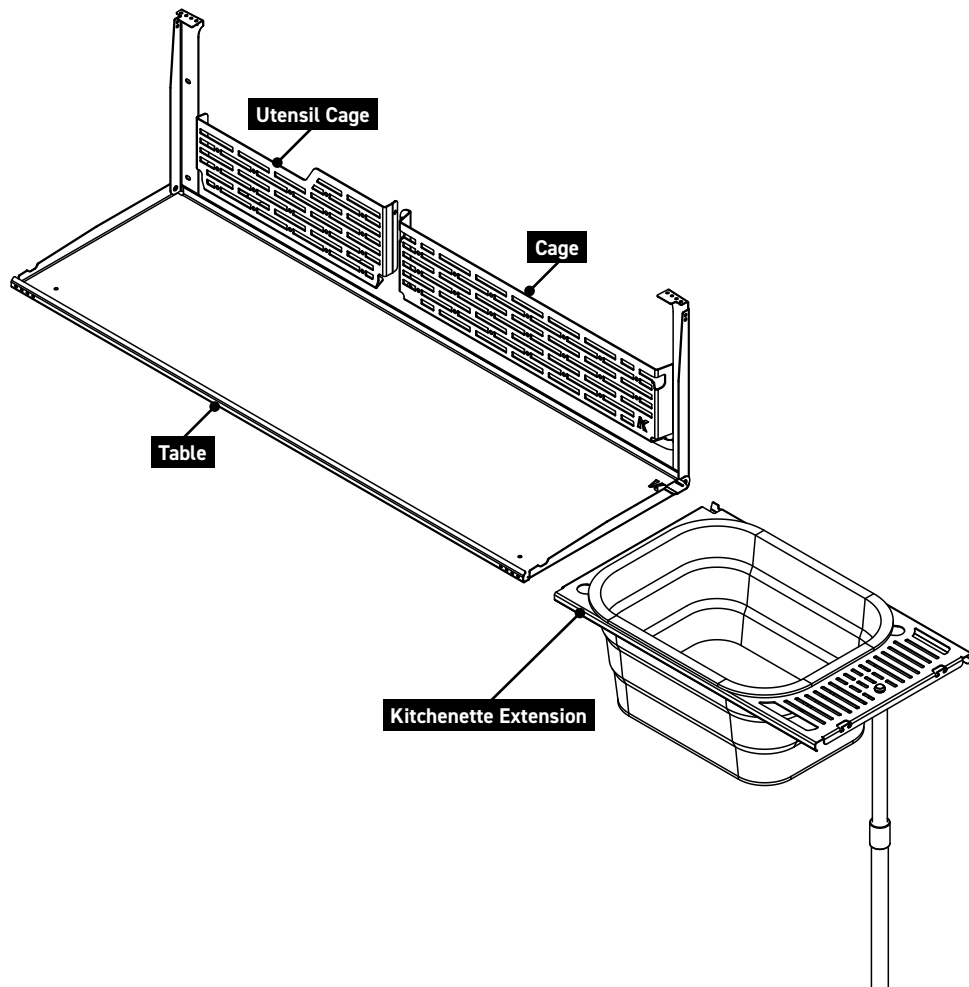

With the order sorted, let's get to the good part: installing. →

Let's get to work.

Preparing the Vehicle

1. If you're installing the Cage at the same time, we recommend completing it first.
2. Open the LHS factory panel cover and remove both the cover and tool set within. We recommend storing these tools in a tool bag within your vehicle. Set the factory panel cover and tool tray to one side for safe keeping if you wish to keep them, they will not be reused during installation.
3. Position the cage inside the recess as shown, ensuring the tabs are positioned within the cutouts.
There is a metal bracket behind the plastic, ensure that the cage tab sits behind the metal bracket.
4. Ensure that it rests firmly against the bottom.
5. Press the cage firmly against the back and mark the position of the side holes. They can be accessed through the openings in the front of the cage.
6. Using a 3mm drill bit, carefully drill a pilot hole in the plastic trim at the marked positions.

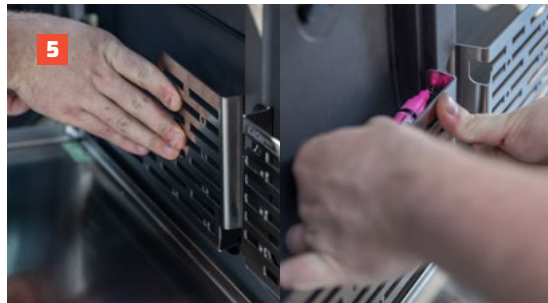

Installing the Cage and Trim Plugs

7. Install the two self-tapping screws. The screws will need to be held in position whilst a screwdriver is fed through the openings in the front of the cage. **DO NOT OVER TIGHTEN.**
8. Install the trim plugs by pushing them into the openings left in the rear door, as shown.



Installing the Retainer Cord

9. We provide a retainer cord to assist with storing taller items securely. The position of this cord is ultimately up to you. We recommend locating each end 85mm down from the top of the hatch, and 20mm inset on each side.
10. Mark the desired locations with a pencil.
11. Using a 3mm drill bit, carefully drill a pilot hole in the plastic trim at the marked positions.
12. Using an 8mm drill bit, carefully drill the hole to it's final size.
13. Thread the TPU retainer plug onto the retainer bungee cord, before tying a knot in the end of the cord.

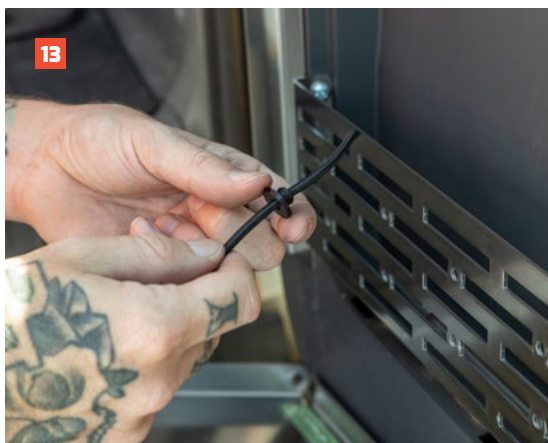

Installing the Retainer Cord cont.

14. Push the knot through the 8mm hole. It may help to use a screwdriver or similar to do this.
15. Push the retainer plug into the hole. This will secure the cord and prevent it from pulling out.
16. Tie the other end of the cord just short of the second hole, as shown. This will pretension the cord.
17. Repeating steps 14 and 15 for the other side.
18. That's it, you're done!

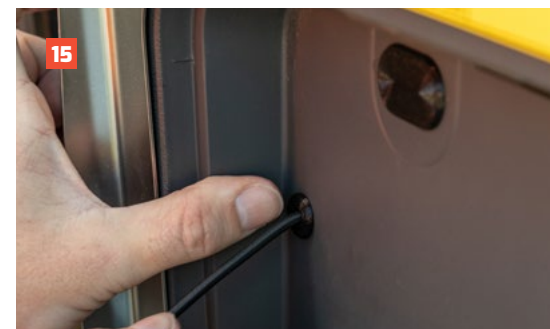
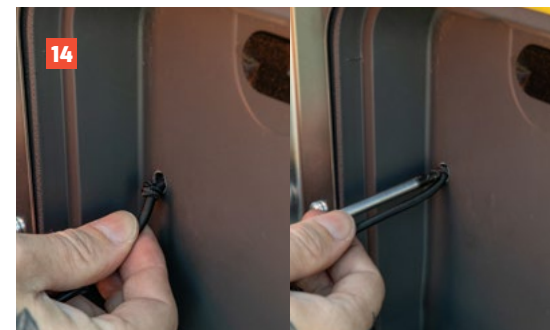



Local Knowledge & Assistance

We know half the fun of building your dream 4x4 is getting your hands dirty. But we also know that sometimes, things don't go to plan. If in the pursuit to build the ultimate setup you find yourself off-track, we're here to help you get unstuck.

For further information call 07 3180 1470 or email info@kaon.com.au

Disclaimer: The products sold by KAON should not be modified, and are for use only on the vehicles specifically stated. KAON will not be liable for any damages arising out of the use or misuse of its products. It is the customers responsibility to ensure the products are safely and properly used and installed. KAON consistently seeks to improve its products and reserves the right to make changes to any product.