



FITTING INSTRUCTIONS FOR

Side Molle Panels

SKU

KS0672

COMPATIBILITY

Mitsubishi Pajero Gen 4

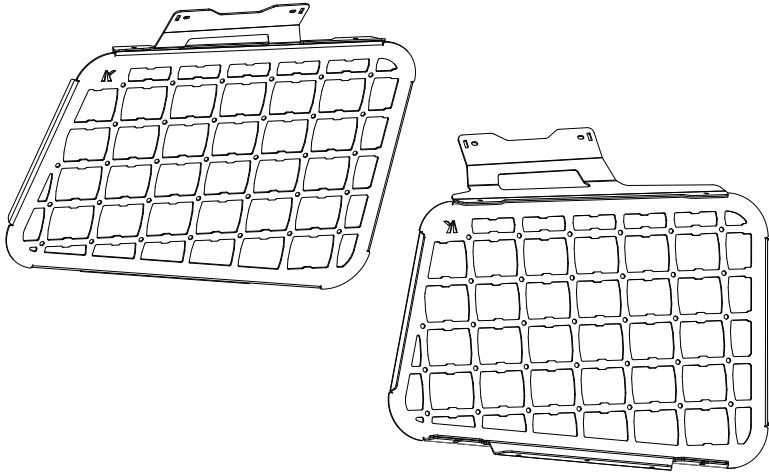

Included contents

QTY	COMPONENT	QTY	COMPONENT
2	Side Molle Panel (LHS & RHS)	8	M6 x 16 Flanged Hex Bolt G8.8
2	Handle Bracket (LHS & RHS)	4	M6 Flanged Nut
2	Lower Bracket	8	M6 X 18 X 1.6 DIN Flat Washer
4	Spacer	6	Self Tapping Screw



Time

30 minutes / Half a beer

For further information contact KAON on **07 3180 1470** or info@kaon.com.au

It all works together.

All our storage products work together, but there is a certain order to installing.
Let's work out the best order for your setup, shall we?

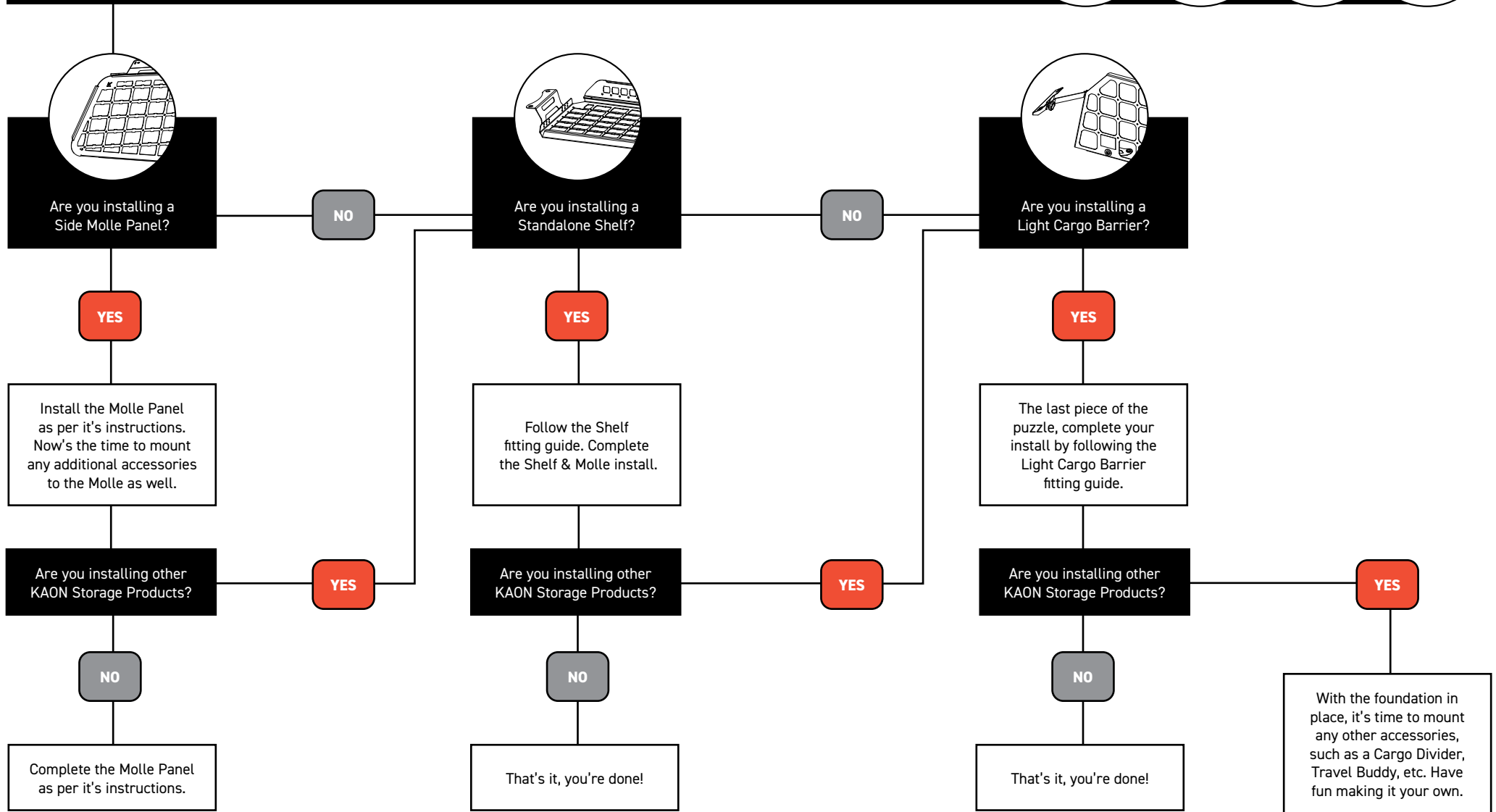
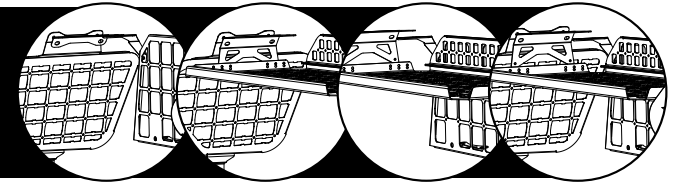

With your setup order sorted, let's get to the good part: installing. →

Let's get to work.

Preparing the Vehicle

1. Whether you're starting from a factory rear, or with existing KAON accessories, we need to start from a blank slate. Remove the rear grab handles by prying off the plastic cover and removing the bolts with a 8mm socket.

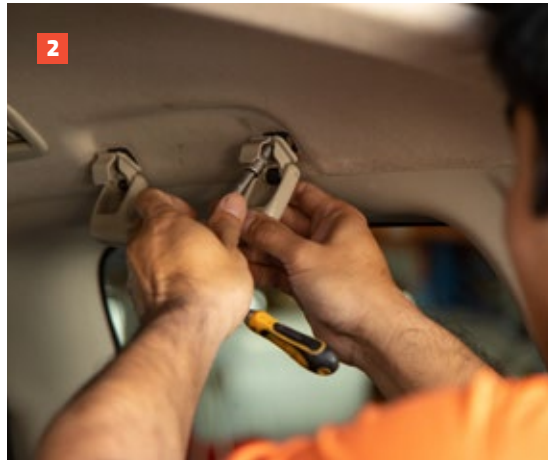

Preparing the Molle Panels

2. Ensure you have the correct panel for each side. The 'K' on each panel should be oriented at the rear of the vehicle.
3. Use M6 bolts, washers and nuts to attach the handle bracket to each Molle Panel, with the long part of the handle bracket towards the front.
4. Attach the lower bracket to the inside of the lower fold of the Molle Panel. Use M6 bolts and washers and secure to the nutserts.

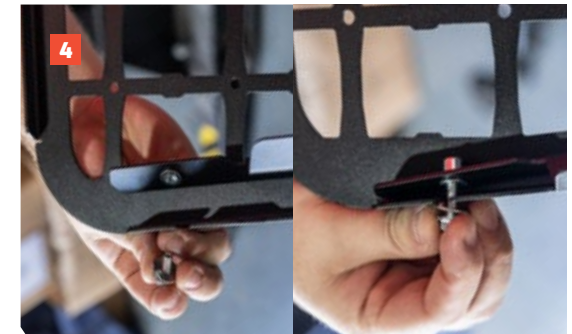

Preparing the Lower Mounting Position

5. If you are installing other KAON storage products at the same time, it's easiest if these are left out for this step.
6. Thread the handle brackets over the rear grab handles, ensuring brackets are oriented as pictured.
7. Reattach the grab handles with the Molle Panel. The grab handles should be secure, but will need to come out again, so there is no need for them to be tightened.
8. This next step is easier if you have an extra set of hands to hold the panel in place. While using a straight edge to ensure the panel is flush with the trim, mark the holes to drill for the lower bracket.
9. With the holes marked, uninstall and remove the panel from the vehicle.
10. Uninstall the lower bracket from the Molle Panel. Loosen the bolts until the bracket easily slides out of the slots on the panel. Leaving the bolts partially installed will make reinstallation easier.
11. Use a 3mm bit to drill the marked holes.
12. Attach the lower bracket to these holes using supplied self tapping screws.
13. Repeat for the other side.

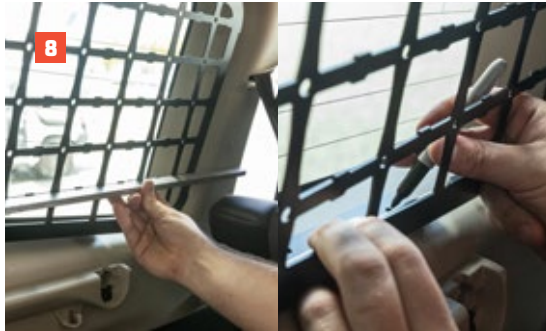
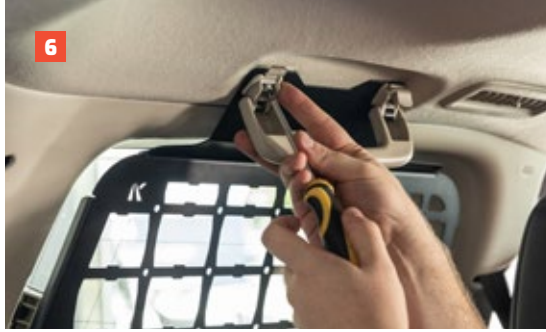

Installing the Molle Panels

14. Now is the best time to attach any accessories such as pouches, electrical components, or storage pods to your panels.
15. Reattach the grab handles and Molle Panels using the factory handles and hardware.

If you're installing with a Standalone Shelf and/or Cargo Barrier: their handle brackets should be sandwiched between the Molle Panels and factory mounts at this stage.

The supplied rectangular spacer is also to be installed at this stage, layered between the factory handle and shelf/barrier handle bracket.

The Standalone Shelf handle bracket has provision for both Shelf and Cargo Barrier mounting. If you are installing both, use only the Shelf handle bracket.

16. The Molle Panels lower fold will sit under the lower bracket. The Molle Panels slot should then slide between the bracket and washer.
17. Tighten all bolts to secure.
18. That's it, you're done! If you are installing a Shelf or Light Cargo Barrier with your panels, continue with the instructions in their fitting guides.

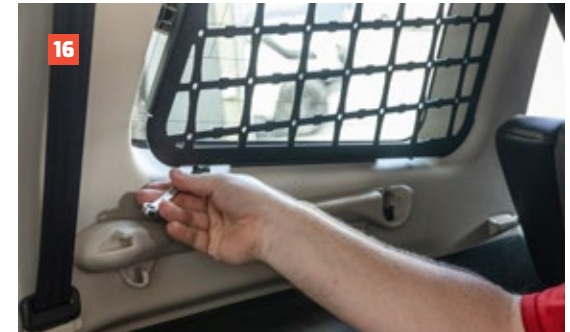
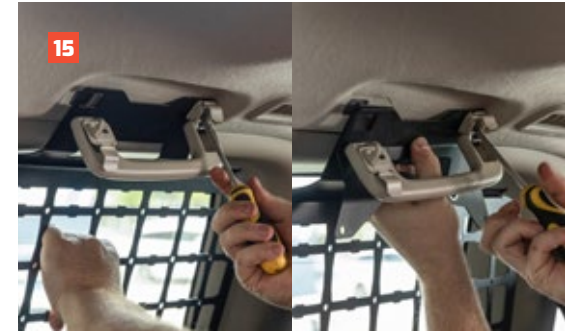

Bolt Torque

DIAMETER (mm)	5mm	6mm	8mm	10mm	12mm
NEWTON-METRES (Nm)	5 Nm	9 Nm	22 Nm	44 Nm	77 Nm



Local Knowledge & Assistance

We know half the fun of building your dream 4x4 is getting your hands dirty. But we also know that sometimes, things don't go to plan. If in the pursuit to build the ultimate setup you find yourself off-track, we're here to help you get unstuck.

For further information call 07 3180 1470 or email info@kaon.com.au

Disclaimer: The products sold by KAON should not be modified, and are for use only on the vehicles specifically stated. KAON will not be liable for any damages arising out of the use or misuse of its products. It is the customers responsibility to ensure the products are safely and properly used and installed. KAON consistently seeks to improve its products and reserves the right to make changes to any product.