



FITTING INSTRUCTIONS FOR

Roof Rack Table Slide

SKU

KS0553/580/581/582

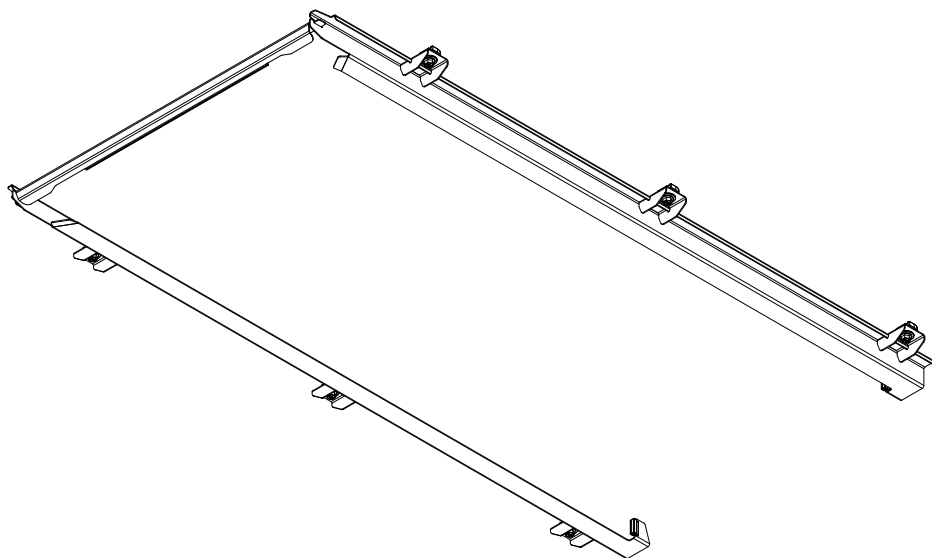

Scan the **QR code** to watch the video installation guide,
or for further information contact KAON on **07 3180 1470** or **info@kaon.com.au**



Included contents.

To suit Rhino-Rack Pioneer Platform Series 4

KS0581

QTY	COMPONENT	QTY	COMPONENT
2	Table Slide Brackets (LHS & RHS)	6	M8 x 20 Hex Bolt
6	Clamps	6	M8 x 24 x 2.0 DIN Flat Washer
1	Locking Bar	6	M8 Channel Nut with Spring

To suit Rhino-Rack Pioneer Platform Series 5/6

KS0582

QTY	COMPONENT	QTY	COMPONENT
2	Table Slide Brackets (LHS & RHS)	6	M8 x 20 Hex Bolt
6	Clamps	6	M8 x 24 x 2.0 DIN Flat Washer
1	Locking Bar	6	M8 Aluminium Slot Nut

To suit Front Runner Slimline II

KS0580

QTY	COMPONENT	QTY	COMPONENT
2	Table Slide Brackets (LHS & RHS)	6	M8 x 20 Hex Bolt
6	Clamps	6	M8 x 24 x 2.0 DIN Flat Washer
1	Locking Bar	6	M8 Nyloc Nut



1-2 hours. This is a trickier install. We recommend getting a mate to help, maybe even offering them a carton. While you're at it, get yourself one too. But when it's done, we promise it's worth it!

Let's get to work.

Preparation

1. Confirm that your rack has the required 50mm clearance to install this product.

If you have purchased our Backbone Spacer Kit (KS0595/KS0607): proceed with that provided fitting guide first.

If you are purchasing your own spacers: we recommend you do this before getting started. Note that if your vehicle already has any spacers installed, you will also need longer bolts.

2. We also recommend purchasing the table compatible with our mount before starting the install. A link to the Marquee 4ft Trestle Table can be found on our website, and is available from Bunnings both instore or online. If purchasing instore, we recommend ensuring the table purchased is as straight as possible.
3. Depending on your setup and preference, there are three ways to go about this installation:

- A. Take your rack off the vehicle altogether, and reinstall once completed.
- B. Undo one side of your rack mounts and loosen off the other, allowing you to lift the rack from one side to gain better access.
- C. Complete the installation with the rack as-is on the car – but depending on your clearance, this can be tricky.

If you decide on option B or C, we recommend placing a blanket over the roof of your car during install to protect it.



Installation

- First, work out the desired mounting position on your rack. The clamps secure to the channels that run across the width of vehicle on the rack underside. We provide 3 sets of mounting clamps (6 total) for the best result, but depending on your roof rack you can install just 2 sets of clamps (4 total).

- Next, position the clamp hardware:

For Rhino-Rack Series 4:

Insert the channel nut with spring in the channel before twisting to lock it's location, roughly in the desired final position.

For Rhino-Rack Series 5/6:

Insert the slot nut into the channel through the wider opening, before sliding roughly to the desired final position.

For Front Runner:

Insert the Hex Bolt into the channel through the bolt opening, before sliding roughly to the desired final position.

- With the hardware roughly in position, loosely install the clamps.

For Rhino-Rack Series 4, 5 & 6:

Thread the bolt through the supplied washer and clamp, and into the nuts as pictured. Loosely secure to the roof rack.

For Front Runner:

Position the clamp over the bolt thread on the base on the rack. Loosely secure with a washer and nyloc nut.

Ensure the clamps are installed securely enough to hold their positioning, but loosely enough that there is sufficient room to slide the mounting brackets in.

- Confirm that the clamps are roughly straight and lined up.

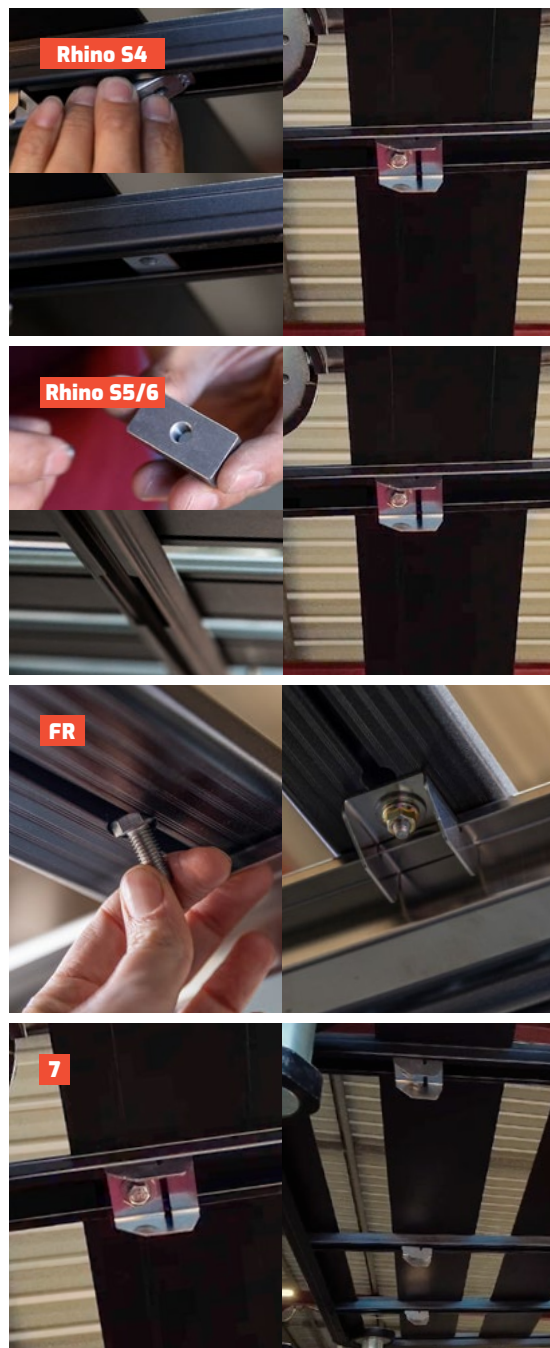

Installation cont.

- The table slide brackets are handed, please note the correct orientation, as pictured. The pinchweld bumper is to be positioned towards the front of the rack/vehicle.
- The easiest way to install the slide brackets is to feed them through the channel in each of the clamps, starting from the rear of the rack.
- Position the slide so that it's flush with end of the roof rack, and confirm that it is square and parallel to the outer edge of the rack.
- Tighten all the clamp hardware so the mount is secure.
- Repeat steps 5-9 for the other side, with the rail roughly the table width apart. Use the locking bar to gauge this distance. Tighten the clamps until they're almost secure, but leave them loose enough that they can still be adjusted to their final position.

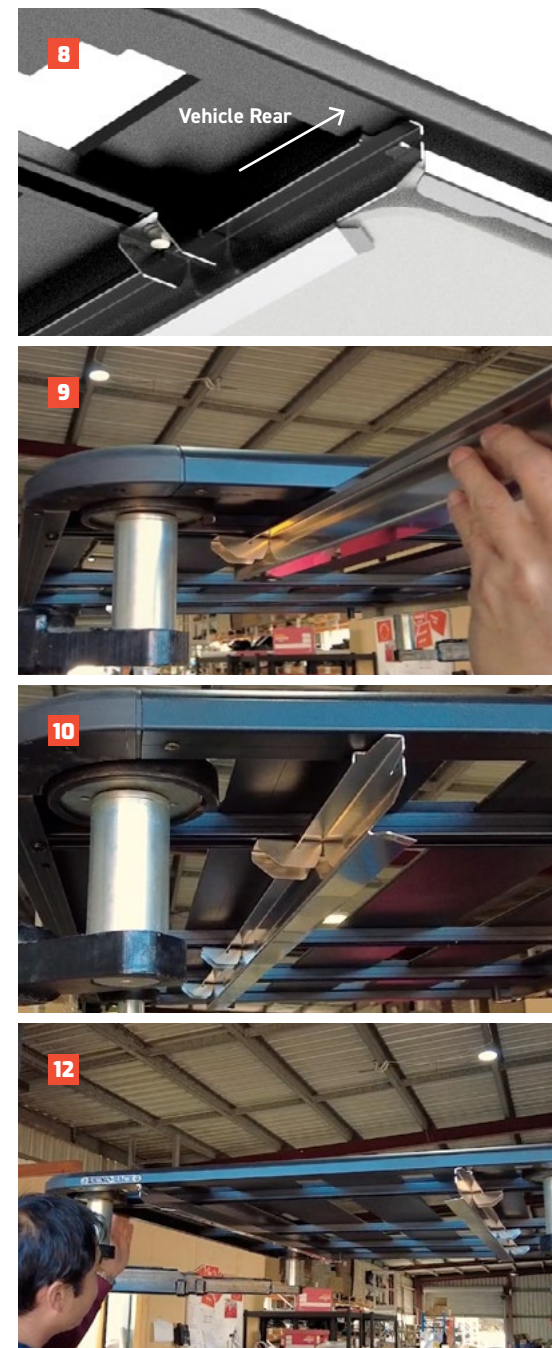

Setting the width

13. The two table slides need to be positioned 622mm apart from outer edge to outer edge, as pictured.
14. The easiest way to set this width is to carefully feed the table into the mount with the legs facing down. While feeding the table into position, push the loosely secured table slide bracket and clamps across, so they are snug against the table's edge and supporting its weight.
15. We don't want the mounts to be too tight, so we recommend wedging a piece of cardboard in between the table and the mount at each end.
16. Check that the table is square by inspecting the bumpers at the rear of the mount (front of the vehicle). The table should be evenly and firmly pressed against both.
17. With the cardboard spacing still in place, tighten all the clamps – we recommend a ratcheting spanner for this.
18. With the mounts secured, remove the cardboard pieces and check that the table slides out of the mount freely.
19. If you uninstalled or loosened your rack to complete the install, reinstall all bolts and secure.
20. Secure the table in place using the locking bar. To learn how to use the locking bar or for information about storing your table, see page 7.

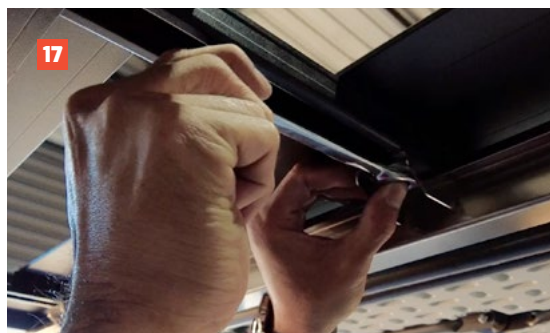
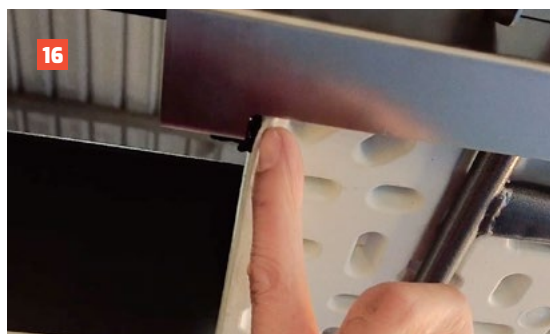
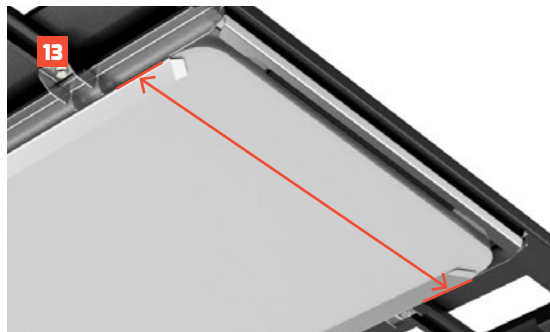

Storing the table

The table can be stored with the legs facing upwards or downwards, depending on personal preference.

Legs facing upwards:

- Keeps table surface cleaner
- Recommended for rough roads to ensure the legs remain secure
- Can result in water collection if the vehicle is stationary for a period of time in adverse weather

Legs facing downwards:

- If your table is warped or bent, this orientation ensures that the leg mechanisms don't get hung up on the rack
- Can result in a dirtier surface
- If your table has broken retaining clamps, there is a risk that the legs may come down during transit

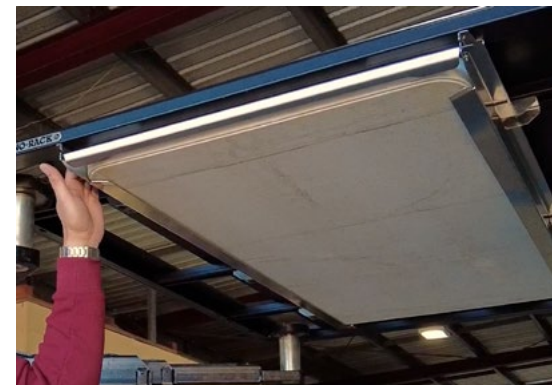

Operating the slide

To lock:

To lock the table in place, place the locking bar tabs into the cutouts on the slide mounts as pictured. To secure, push forwards and then down until the bar locks into position.

While not required for transit, you have the option of further securing the locking bar and table by passing a padlock through the holes on either or both sides of the mount.

The holes on the bar are slightly offset from the mount to ensure the lock is pinched into position and doesn't rattle. We recommend using the Maxtrax Maxlox, as they have a silicone outer sleeve.

To release:

To release the locking bar, push forward and then up on the bar.

Storage:

When not in use, we recommend storing the table and locking bar together in a safe place.



Local Knowledge & Assistance

We know half the fun of building your dream 4x4 is getting your hands dirty. But we also know that sometimes, things don't go to plan. If in the pursuit to build the ultimate setup you find yourself off-track, we're here to help you get unstuck.

For further information call 07 3180 1470 or email info@kaon.com.au

Disclaimer: The products sold by KAON should not be modified, and are for use only on the vehicles specifically stated. KAON will not be liable for any damages arising out of the use or misuse of its products. It is the customers responsibility to ensure the products are safely and properly used and installed. KAON consistently seeks to improve its products and reserves the right to make changes to any product.