



FITTING INSTRUCTIONS FOR

Side Molle Panels

SKU

KS0542

COMPATIBILITY

Suzuki Jimny JB74

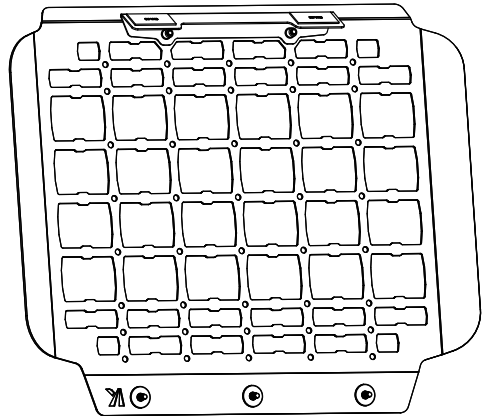
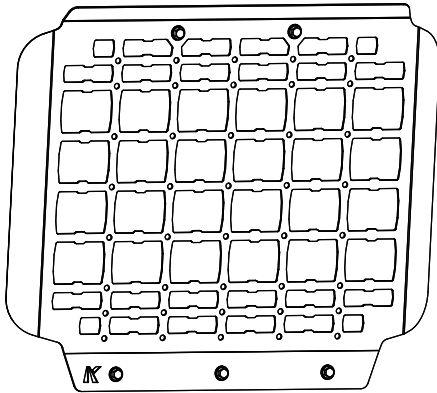

Included contents

QTY	COMPONENT	QTY	COMPONENT
2	Side Molle Panel (LHS & RHS)	4	M6 Nutsert
2	Bracket (with Automotive Grade Tape)	14	M6 X 18 X 1.6 DIN Flat Washer
1	M8 Serrated Flanged Nut	14	M6 x 16 Flanged Hex Bolt G8.8
1	M6 Socket Head Cap Screw	6	M8 x 24 x 2.0 DIN Flat Washer



Time

30 minutes / Half a beer

Scan the **QR code** to watch the video installation guide,
or for further information contact KAON on **07 3180 1470** or info@kaon.com.au



Let's get to work.

Each Side Molle Panel mounts to captive nuts along the bottom, and a bracket along the top. There are two options for securing the top: automotive-grade mounting tape, or nutserting into the vehicle frame.

Both provided options ensure strong and secure mounting, so which option you choose depends on how permanent you want the panels to be, as well as the intended use.

Installation

1. Regardless of mounting preference, start by securing the bracket to the Side Molle Panel with M6 washers and bolts, as pictured. Position the bracket at the lowest point of the slots. Tighten slightly to ensure it maintains its position.
2. Peel off the tape backing on the brackets.
3. For each panel, ensure the 'K' cutout faces towards the back of the vehicle.
4. Loosely mount the two bottom outer bolts to ensure the panel is correctly aligned, before pushing the bracket and panel against the frame and upwards. Ensure the tape adheres to the frame. We recommend poking a finger through the mesh and pushing against the bracket to ensure proper adhesion.
5. Remove the all bolts, leaving the top bracket in place.
6. Apply pressure to the bracket to ensure it is thoroughly adhered.

To complete the install with nutserts, go to page 3.

To complete the install with the mounting tape, go to page 4.

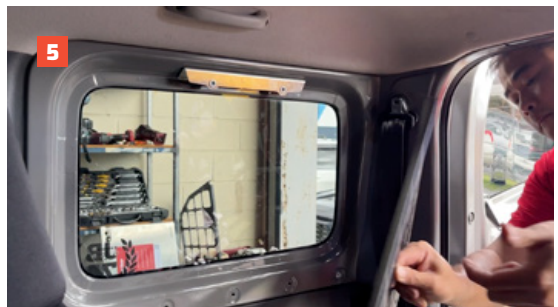
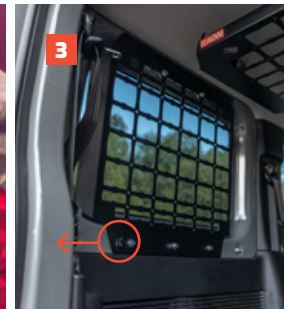

Complete Installation with Nutserts

7. With the bracket stuck in place, drill 3mm pilot holes in centre of the bracket mounting slots. The airbags sit up behind the fabric of the roof, so drilling in this location is okay.
8. With the pilot holes drilled, pull the bracket off the vehicle (it may take a little force!), and peel the automotive tape off the back of the bracket.
9. Open up the pilot holes using a 9.5mm drill bit. If you have one on hand, a stepped drill bit will make this easier.
10. Use a cotton tip and some paint to tidy up the holes and prevent rust.
11. If you have a nutsert gun, use it to install the nutserts. Otherwise, set up the nutsert on the provided M8 serrated nut and M6 bolt as pictured. Using an allen key and a ring spanner, we recommend starting the nutsert until there is a slight bulge. Then set the nutsert into the drilled roof hole and tighten until you feel that it has clamped onto the vehicle. Once set, remove the bolt and serrated nut, leaving the nutsert in the roof. Repeat for the other hole.
12. Secure the bracket to the nutserts using M6 bolts and washers. Ensure the bracket is straight before tightening.
13. Secure the panel to the bracket using the M6 bolts and washers. To secure the bottom, use M6 bolts and washers with an M8 washer behind the panel as a spacer.
14. Make any necessary adjustments to the Molle Panel before tightening all bolts.
15. Repeat on the other side.
16. That's it, you're done!



Complete Installation with Mounting Tape

17. If you've selected to use the automotive-grade mounting tape, ensure the bracket is securely adhered by applying pressure to it.
18. Finish installing by securing the panel to the top bracket again using the M6 bolts and washers. To secure the bottom, use M6 bolts and washers with an M8 washer behind the panel as a spacer.
19. Make any necessary adjustments to the Molle Panel before tightening all bolts.
20. Repeat on the other side.
21. That's it, you're done!



Bolt Torque

DIAMETER (mm)	5mm	6mm	8mm	10mm	12mm
NEWTON-METRES (Nm)	5 Nm	9 Nm	22 Nm	44 Nm	77 Nm



Local Knowledge & Assistance

We know half the fun of building your dream 4x4 is getting your hands dirty. But we also know that sometimes, things don't go to plan. If in the pursuit to build the ultimate setup you find yourself off-track, we're here to help you get unstuck.

For further information call 07 3180 1470 or email info@kaon.com.au

Disclaimer: The products sold by KAON should not be modified, and are for use only on the vehicles specifically stated. KAON will not be liable for any damages arising out of the use or misuse of its products. It is the customers responsibility to ensure the products are safely and properly used and installed. KAON consistently seeks to improve its products and reserves the right to make changes to any product.