



FITTING INSTRUCTIONS FOR

Rear Hinge Aerial Mount

SKU

KS0466/537

COMPATIBILITY

Toyota Prado 150 & Lexus GX 460

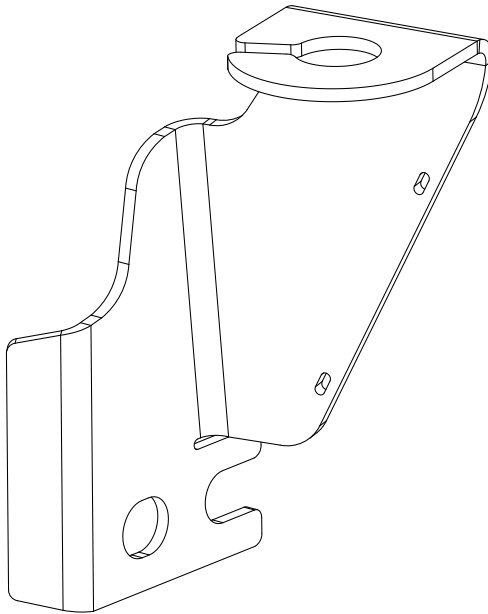

Included contents

QTY	COMPONENT	QTY	COMPONENT
1	Aerial Mount Bracket	2	Small Cable Tie



Time

30 minutes / Half a beer

Scan the **QR code** to watch the video installation guide,
or for further information contact KAON on **07 3180 1470** or **info@kaon.com.au**



Bolt Torque

DIAMETER (mm)	5mm	6mm	8mm	10mm	12mm
NEWTON-METRES (Nm)	5 Nm	9 Nm	22 Nm	44 Nm	77 Nm

Let's get to work.

Preparation

1. First you'll need to remove the two bolts that secure the brake light, as pictured.
2. Push on the light gently to unclip it and move it away from the body. This creates a gap to allow better access to the top 12mm hinge bolts.
3. Using a ring spanner, remove the top LHS bolt entirely. These bolts are tight from factory, so be careful not to round the heads.
4. Loosen the RHS bolt until you have a 3mm gap.

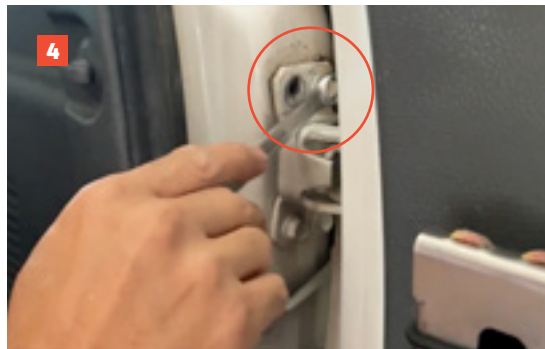
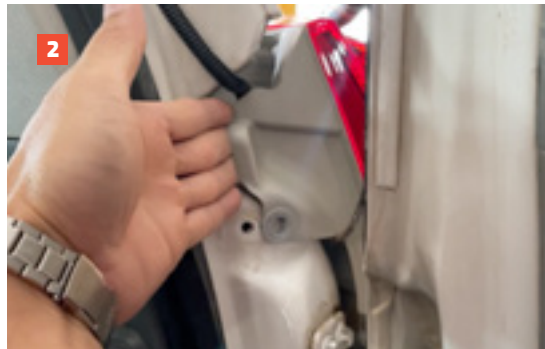

Installation

These images show the standard bracket, but the process for the Flat Tailgate Mount (KS0537) is the same.

1. With the hinge prepped, now is the time to think about how you want to run the coaxial cable for your chosen aerial. There are two options: the easiest option is to run it downwards and through the rubber grommet into the cabin. The other is to run it behind the brake light, which requires removing the entire brake light.
2. With your coaxial sorted, the next thing to do is to mount the aerial to the bracket, and use the provided zip ties for cable management. Ensure the cable is positioned on the edge of the bracket as shown, so that it doesn't get pinched between the door and the light.
3. Position the bracket on the vehicle, paying attention to the cable location. Slide the slot under the RHS bolt and tighten the bolt, but not all the way – we need to be able to manoeuvre the bracket still.
4. Push the brake light back into position and confirm the position of the bracket. We want the space around it to be small and even. If you have the Flat Tailgate bracket, confirm that the top rear hatch opens clear of the bracket.
5. With the bracket position confirmed, tighten the RHS bolt, ensuring that the bracket does not move whilst doing so.
6. Reinstall the LHS bolt and tighten.
7. Confirm the coaxial cable position, and reinstall the two brake light bolts and tighten.
8. Double check that the gaps surrounding the bracket have been maintained, both with the door open and closed. That's it, you're done!

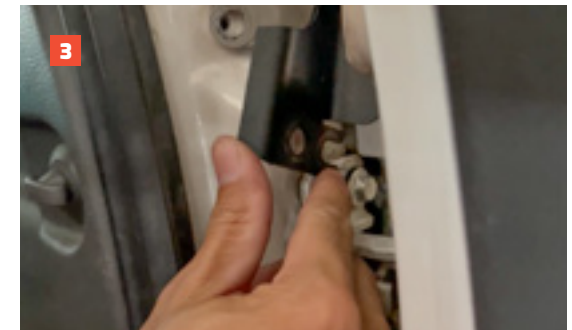



Local Knowledge & Assistance

We know half the fun of building your dream 4x4 is getting your hands dirty. But we also know that sometimes, things don't go to plan. If in the pursuit to build the ultimate setup you find yourself off-track, we're here to help you get unstuck.

For further information call 07 3180 1470 or email info@kaon.com.au

Disclaimer: The products sold by KAON should not be modified, and are for use only on the vehicles specifically stated. KAON will not be liable for any damages arising out of the use or misuse of it's products. It is the customers responsibility to ensure the products are safely and properly used and installed. KAON consistently seeks to improve it's products and reserves the right to make changes to any product.