



FITTING INSTRUCTIONS FOR

Catch Can Bracket

SKU

KS0437

COMPATIBILITY

Mitsubishi Pajero NX Automatic

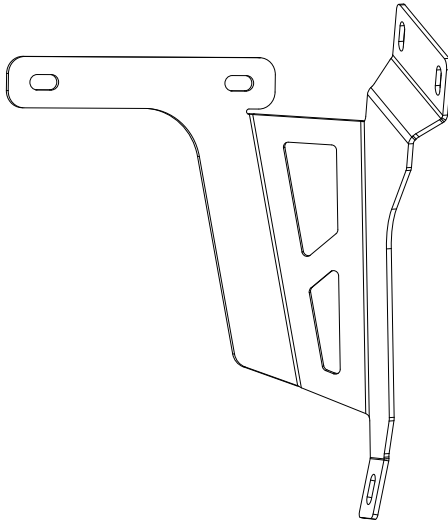

Included contents

QTY	COMPONENT	QTY	COMPONENT
1	Catch Can Bracket	2	M8 Nyloc Nut
2	M6 x 16 Flanged Hex Bolt G8.8	2	M6 X 18 X 1.6 DIN Flat Washer
3	M8 x 25 Flanged Hex Bolt G8.8	3	M8 x 17 x 1.2 Washer



Time

45 minutes / One beer (*Maybe grab a cheeky second for the actual catch can install!*)

For further information contact KAON on **07 3180 1470** or info@kaon.com.au

Bolt Torque

DIAMETER (mm)	5mm	6mm	8mm	10mm	12mm
NEWTON-METRES (Nm)	5 Nm	9 Nm	22 Nm	44 Nm	77 Nm

Let's get to work.

Preparation

1. First off, you want to locate the three captive mounting hole we're going to use to install this bracket, on the drivers side of the engine bay. Remove the screws pictured adjacent, and tuck the braided earth lead to one side for a moment.

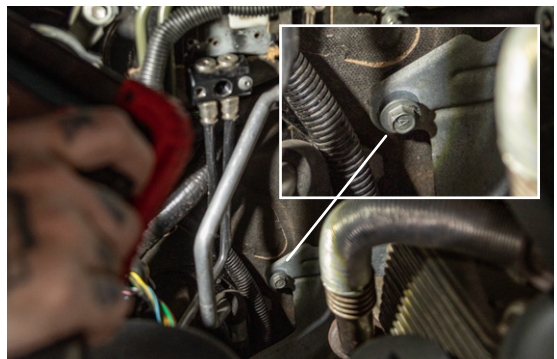
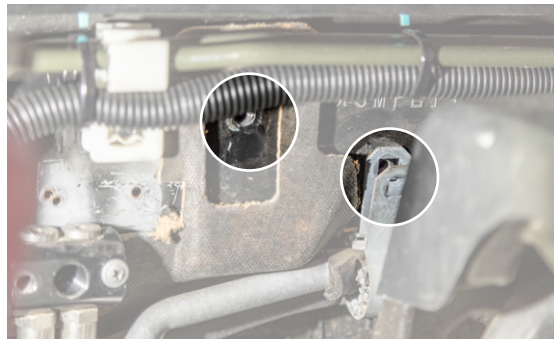
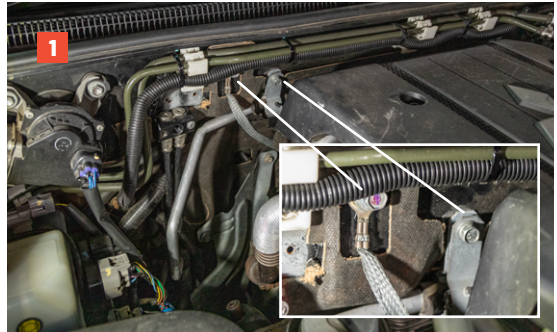

Bracket Installation

1. Using one of the provided M6 screws and washers, loosely attach the bracket to the top right captive nut.
2. Using the remaining M6 screw and washer, loosely attach the bottom of the bracket to the lower captive nut.
3. Thread the earth lead we removed earlier over one of the provided M8 screws, before using it to secure the top left captive nut.

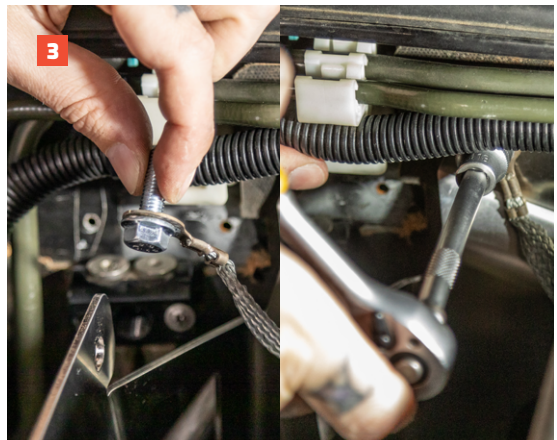
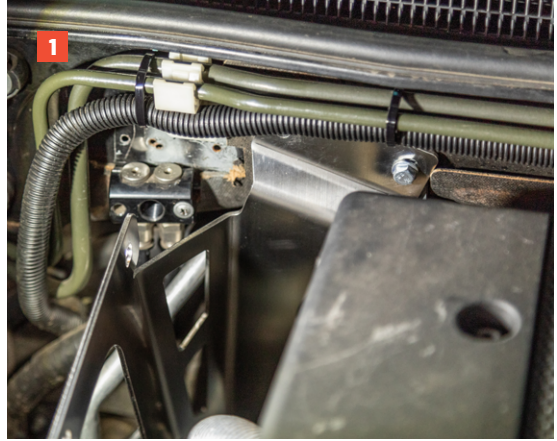

Attaching the Catch Can

1. Using the remaining provided M8 screws, washers and nuts, attach the catch can to the bracket as pictured. You may need to pivot the catch can within it's own plastic mount.
2. With the catch can positioning confirmed, secure all the screws.
3. That's it, your bracket is done! Now it's time to install the catch can, and we'll leave the how-tos for that bit to the good folk at Mann+Hummel.



Local Knowledge & Assistance

We know half the fun of building your dream 4x4 is getting your hands dirty. But we also know that sometimes, things don't go to plan. If in the pursuit to build the ultimate setup you find yourself off-track, we're here to help you get unstuck.

For further information call 07 3180 1470 or email info@kaon.com.au

Disclaimer: The products sold by KAON should not be modified, and are for use only on the vehicles specifically stated. KAON will not be liable for any damages arising out of the use or misuse of it's products. It is the customers responsibility to ensure the products are safely and properly used and installed. KAON consistently seeks to improve it's products and reserves the right to make changes to any product.