



FITTING INSTRUCTIONS FOR

# Spare Tyre Spacer 6mm

PART NUMBER

**KS0348**

COMPATIBILITY

**Toyota Prado 120 & 150**

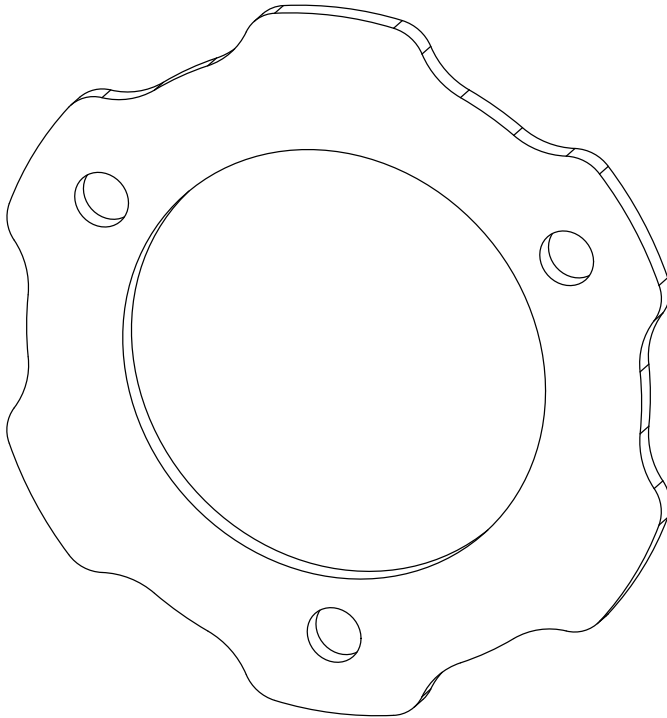

## Included contents

QTY	COMPONENT
1	6mm Spare Tyre Spacer



**Time**

15 minutes / Swig of beer

Scan the **QR code** to watch the video installation guide,  
or for further information contact KAON on **07 3180 1470** or [info@kaon.com.au](mailto:info@kaon.com.au)



## Bolt Torque

DIAMETER (mm)	5mm	6mm	8mm	10mm	12mm
NEWTON-METRES (Nm)	5 Nm	9 Nm	22 Nm	44 Nm	77 Nm

# Let's get to work.

---

## Preparation

1. The spacer is designed to provide additional clearance between larger wheels or tyres and the rear door. If you're in need of one, you're most likely not running the rear wheel cover and backing plate, but if you are – remove them, and the spare tyre.



---

## Installation

1. Place the spacer over the bolts.
2. Put the spare tyre back on, and start the wheel nuts by hand before tightening until secure.
3. If you find that one spacer is not quite enough, it is possible to purchase and use a second (12mm total).





## Local Knowledge & Assistance

We know half the fun of building your dream 4x4 is getting your hands dirty. But we also know that sometimes, things don't go to plan. If in the pursuit to build the ultimate setup you find yourself off-track, we're here to help you get unstuck.

For further information call 07 3180 1470 or email [info@kaon.com.au](mailto:info@kaon.com.au)

Disclaimer: The products sold by KAON should not be modified, and are for use only on the vehicles specifically stated. KAON will not be liable for any damages arising out of the use or misuse of it's products. It is the customers responsibility to ensure the products are safely and properly used and installed. KAON consistently seeks to improve it's products and reserves the right to make changes to any product.