

PART NUMBER	KS0288
PRODUCT DESCRIPTION	Fire Extinguisher Mount Drivers or Passenger Seat
VEHICLE COMPATIBILITY	Prado 120 without electric seats

Parts

- 1 x Stainless Steel Bracket
- 2 x M8 x 16 Flanged hex bolt
- 2 x M8 Unistrut nut blocks
- 2 x M5 x 12 Flanged hex bolt

- 2 x M5 Flanged hex nut

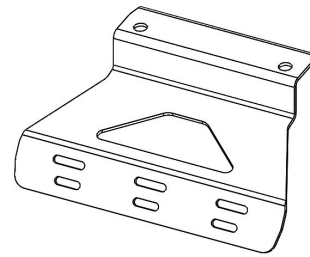

Preparation

Release the seat from the vehicle by removing the 4 bolts that secure the frame to the floor.

Unclip any wiring so that the seat can be positioned for easier access to the underside of the frame.

Installation

Position the bracket as shown and align with two holes in the seat frame channel.

Secure the bracket using 2 M8 bolts and Unistrut nuts.

Re-install the seat and plug back any wiring that was disconnected.

Attach your fire extinguisher using M5 bolts and nuts.

Check that the seat can slide and will lock into position without fouling on the bracket or extinguisher.



BOLT TORQUE	Dia. (mm)	5mm dia	6mm dia.	8mm dia.	10mm dia.	12mm dia.
	(Nm)	5 Nm	9 Nm	22 Nm	44 Nm	77 Nm

**** We recommend applying anti-sieze compound or grease to all bolted connections**
For further information, contact Kaon on (07) 3180 1470 or email info@kaon.com.au